

## Introduction

### Purpose

This document provides instructions to install the I.S. Barrier Security Kit (M09286K001) on Legacy® Ultra-Hi™ units.

*Note: The lock is not included in the kit. The lock must be obtained separately. See the note below the section “Parts List” for lock details.*

### Table of Contents

Topic	Page
<a href="#">Introduction</a>	1
<a href="#">Important Safety Information</a>	2
<a href="#">Installing the Legacy Ultra-Hi I.S. Barrier Security Kit (M09286K001)</a>	4

### Required Tools

The following tools are required for the installation of the kit:

- Phillips® Head Screwdriver
- Conduit Nut Wrenches
- Ratchet
- 1/2” Socket
- 3/8” Socket

### Parts List

The following table lists the parts included in this kit.

Item	Description	Part Number	Quantity
1	Security, Bracket Base	M09263A001	1
2	Security Cover	M09264A001	1
3	Label, Patent Pending	M05621B002	1
4	Snap Bushing	K85071-19	1
5	Washer	N16599-92	3*
6	Screw, M3 X 8	Q12845-34	4
7	Conduit Nut	K93487	1**

\* One spare in case the bottom washer is missing from the unit.

\*\* One spare in case the nut is missing from the unit.

*Note: Lock is not included. The kit is designed to use a Master Lock Series 6270, shackleless round solid steel lock.*

# Important Safety Information

This section introduces the hazards and safety precautions associated with installing, inspecting, maintaining or servicing this product. Before performing any task on this product, read this safety information and the applicable sections in this manual, where additional hazards and safety precautions for your task will be found. Fire, explosion, electrical shock or pressure release could occur and cause death or serious injury, if these safe service procedures are not followed.

## Preliminary Precautions

You are working in a potentially dangerous environment of flammable fuels, vapors, and high voltage or pressures. Only trained or authorized individuals knowledgeable in the related procedures should install, inspect, maintain or service this equipment.

## Emergency Total Electrical Shut-Off

The first and most important information you must know is how to stop all fuel flow to the pump/dispenser and island. Locate the switch or circuit breakers that shut off all power to all fueling equipment, dispensing devices, and Submerged Turbine Pumps (STPs).

**⚠ WARNING**

 The EMERGENCY STOP, ALL STOP, and PUMP STOP buttons at the cashier's station WILL NOT shut off electrical power to the pump/dispenser. This means that even if you activate these stops, fuel may continue to flow uncontrolled.

 You must use the TOTAL ELECTRICAL SHUT-OFF in the case of an emergency and not the console's ALL STOP and PUMP STOP or similar keys.

## Total Electrical Shut-Off Before Access

Any procedure that requires access to electrical components or the electronics of the dispenser requires total electrical shut off of that unit. Understand the function and location of this switch or circuit breaker before inspecting, installing, maintaining, or servicing Gilbarco equipment.

## Evacuating, Barricading and Shutting Off

Any procedure that requires access to the pump/dispenser or STPs requires the following actions:



- An evacuation of all unauthorized persons and vehicles from the work area
- Use of safety tape, cones or barricades at the affected unit (s)
- A total electrical shut-off of the affected unit (s)

## Read the Manual

Read, understand and follow this manual and any other labels or related materials supplied with this equipment. If you do not understand a procedure, call a Gilbarco Authorized Service Contractor or call the Gilbarco Support Center at 1-800-800-7498. It is imperative to your safety and the safety of others to understand the procedures before beginning work.

## Follow the Regulations

Applicable information is available in National Fire Protection Association (NFPA) 30A; *Code for Motor Fuel Dispensing Facilities and Repair Garages*, NFPA 70; *National Electrical Code (NEC)*, Occupational Safety and Hazard Association (OSHA) regulations and federal, state, and local codes. All these regulations must be followed. Failure to install, inspect, maintain or service this equipment in accordance with these codes, regulations and standards may lead to legal citations with penalties or affect the safe use and operation of the equipment.

## Replacement Parts

Use only genuine Gilbarco replacement parts and retrofit kits on your pump/dispenser. Using parts other than genuine Gilbarco replacement parts could create a safety hazard and violate local regulations.

## Safety Symbols and Warning Words

This section provides important information about warning symbols and boxes.

### Alert Symbol



This safety alert symbol is used in this manual and on warning labels to alert you to a precaution which must be followed to prevent potential personal safety hazards. Obey safety directives that follow this symbol to avoid possible injury or death.

### Signal Words

These signal words used in this manual and on warning labels tell you the seriousness of particular safety hazards. The precautions below must be followed to prevent death, injury or damage to the equipment:



**DANGER:** Alerts you to a hazard or unsafe practice which will result in death or serious injury.



**WARNING:** Alerts you to a hazard or unsafe practice that could result in death or serious injury.



**CAUTION** with Alert symbol: Designates a hazard or unsafe practice which may result in minor injury.

**CAUTION** without Alert symbol: Designates a hazard or unsafe practice which may result in property or equipment damage.

## Working With Fuels and Electrical Energy

### Prevent Explosions and Fires

Fuels and their vapors will explode or burn, if ignited. Spilled or leaking fuels cause vapors. Even filling customer tanks will cause potentially dangerous vapors in the vicinity of the dispenser or island.

**No Open Fire**



Open flames from matches, lighters, welding torches or other sources can ignite fuels and their vapors.



**No Sparks - No Smoking**

Sparks from starting vehicles, starting or using power tools, burning cigarettes, cigars or pipes can also ignite fuels and their vapors. Static electricity, including an electrostatic charge on your body, can cause a spark sufficient to ignite fuel vapors. Every time you get out of a vehicle, touch the metal of your vehicle, to discharge any electrostatic charge before you approach the dispenser island.

**Working Alone**

It is highly recommended that someone who is capable of rendering first aid be present during servicing. Familiarize yourself with Cardiopulmonary Resuscitation (CPR) methods, if you work with or around high voltages. This information is available from the American Red Cross. Always advise the station personnel about where you will be working, and caution them not to activate power while you are working on the equipment. Use the OSHA Lockout/ Tagout procedures. If you are not familiar with this requirement, refer to this information in the service manual and OSHA documentation.

**Working With Electricity Safely**

Ensure that you use safe and established practices in working with electrical devices. Poorly wired devices may cause a fire, explosion or electrical shock. Ensure that grounding connections are properly made. Take care that sealing devices and compounds are in place. Ensure that you do not pinch wires when replacing covers. Follow OSHA Lockout/Tagout requirements. Station employees and service contractors need to understand and comply with this program completely to ensure safety while the equipment is down.

**Hazardous Materials**

Some materials present inside electronic enclosures may present a health hazard if not handled correctly. Ensure that you clean hands after handling equipment. Do not place any equipment in the mouth.

**WARNING**

The pump/dispenser contains a chemical known to the State of California to cause cancer.

**WARNING**

The pump/dispenser contains a chemical known to the State of California to cause birth defects or other reproductive harm.

**In an Emergency**

**Inform Emergency Personnel**

Compile the following information and inform emergency personnel:

- Location of accident (for example, address, front/back of building, and so on)
- Nature of accident (for example, possible heart attack, run over by car, burns, and so on)
- Age of victim (for example, baby, teenager, middle-age, elderly)
- Whether or not victim has received first aid (for example, stopped bleeding by pressure, and so on)
- Whether or not a victim has vomited (for example, if swallowed or inhaled something, and so on)

**WARNING**



Gasoline ingested may cause unconsciousness and burns to internal organs. Do not induce vomiting. Keep airway open. Oxygen may be needed at scene. Seek medical advice immediately.

**WARNING**



Gasoline inhaled may cause unconsciousness and burns to lips, mouth and lungs. Keep airway open. Seek medical advice immediately.

**WARNING**



Gasoline spilled in eyes may cause burns to eye tissue. Irrigate eyes with water for approximately 15 minutes. Seek medical advice immediately.

**WARNING**



Gasoline spilled on skin may cause burns. Wash area thoroughly with clear water. Seek medical advice immediately.

**IMPORTANT:** Oxygen may be needed at scene if gasoline has been ingested or inhaled. Seek medical advice immediately.

**Lockout/Tagout**

Lockout/Tagout covers servicing and maintenance of machines and equipment in which the unexpected energization or start-up of the machine(s) or equipment or release of stored energy could cause injury to employees or personnel. Lockout/Tagout applies to all mechanical, hydraulic, chemical or other energy, but does not cover electrical hazards. Subpart S of 29 CFR Part 1910 - Electrical Hazards, 29 CFR Part 1910.333 contains specific Lockout/ Tagout provision for electrical hazards.

## Installing the Legacy Ultra-Hi I.S. Barrier Security Kit (M09286K001)

Inform the Manager that the power will be removed and remove all the power supplied to the unit at the breaker located in the building. Block off the unit from customers.

### **WARNING**

Failure to turn off the unit during the installation of the kit may cause injury or bodily harm from electrical shock. Ensure that all power to the unit is switched off before opening the door to the unit and during kit installation.

To install the Legacy Ultra-Hi I.S. Barrier Security Kit (M09286K001), proceed as follows:

- 1 Remove the lower door on the Junction box side of the unit.
- 2 Remove the panel that covers the I.S. portion of the unit (neck) by removing one screw and lifting up the panel off the tabs. Slide the panel out and downwards to remove. Retain the panel for reinstallation (see [Figure 1](#)).

**Figure 1: Removing the Panel**

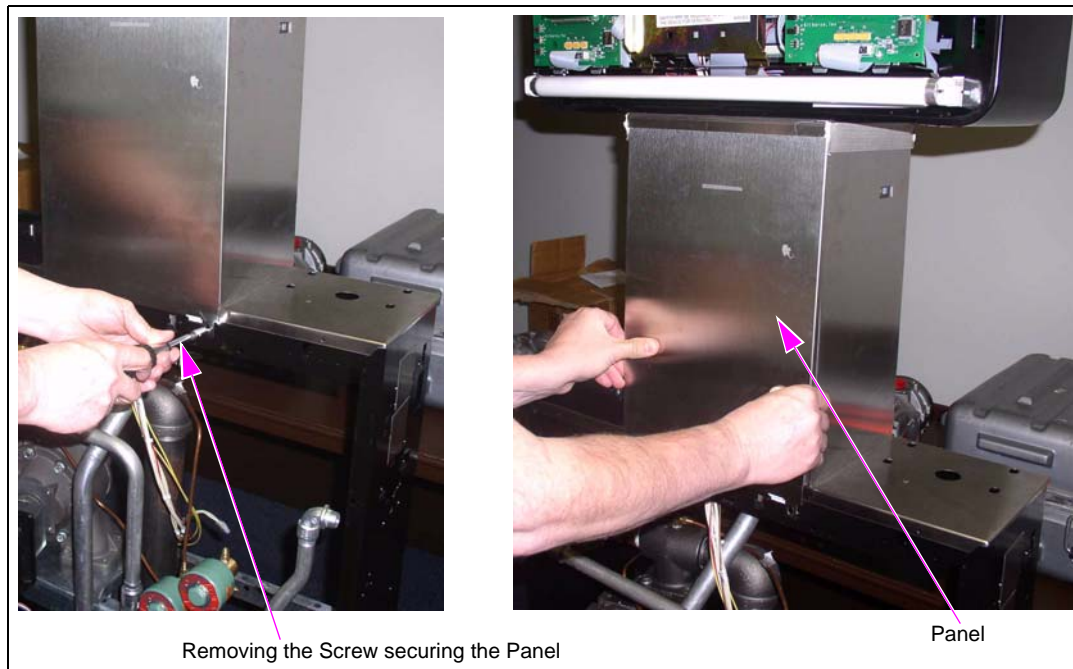

- 3 Disconnect the cable from the bottom of the I.S. Printed Circuit Board (PCB) (see [Figure 2](#)).

**Figure 2: Disconnecting the Cable from the I.S. PCB**

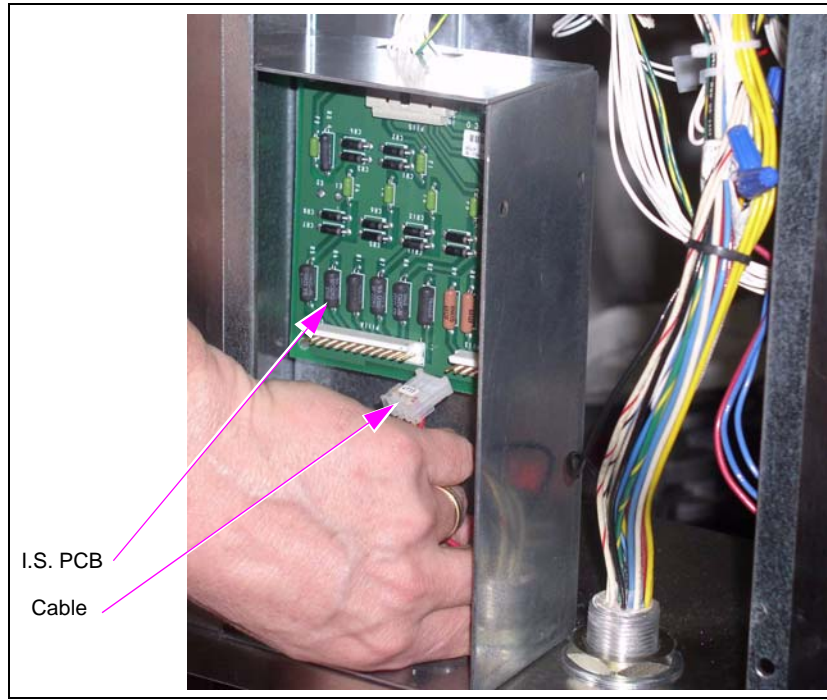

- 4 Remove the conduit nut and move the cables into the lower hydraulics. Reinstall the conduit nut.

**Figure 3: Removing the Conduit Nut and Moving Cables and Conduit Nut**

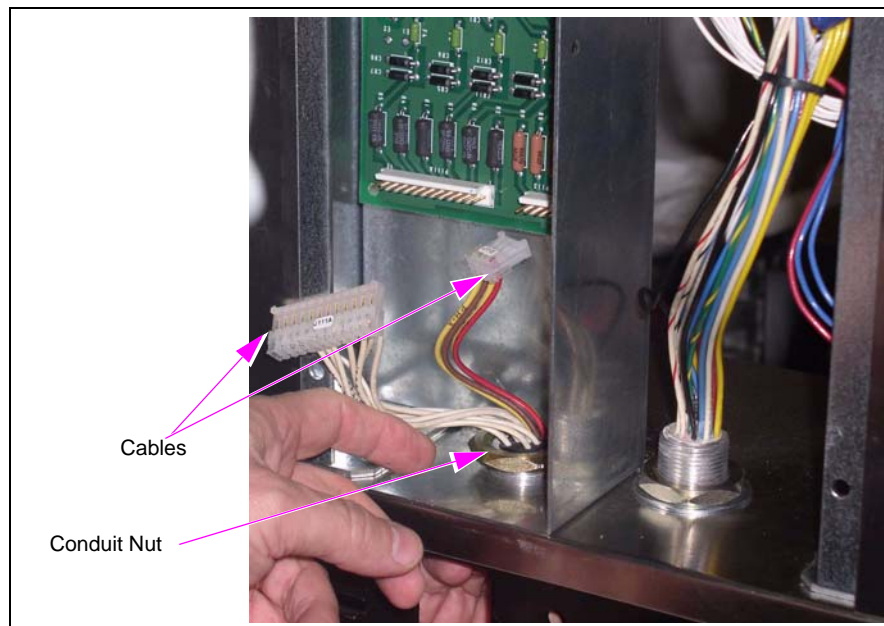

- 5 Remove the screw at the bottom of the I.S. Barrier Bracket.

**Figure 4: Removing the Screw at the Bottom of the I.S. Barrier Bracket**

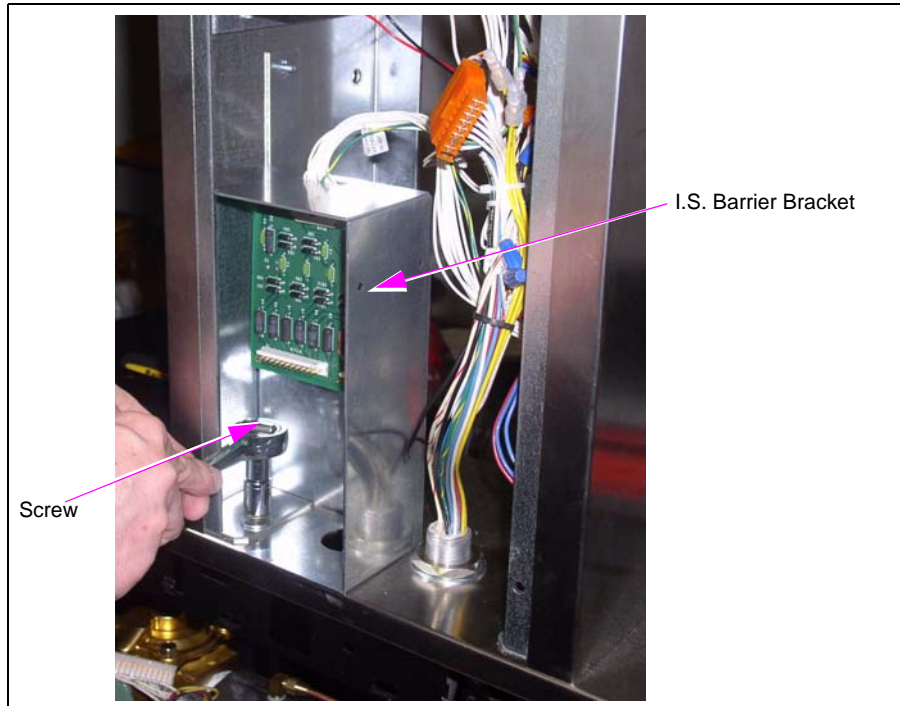

- 6 Remove the I.S. PCB and disconnect the cable at the top of the PCB.

**Figure 5: Removing the I.S. PCB and Disconnecting the Cable**

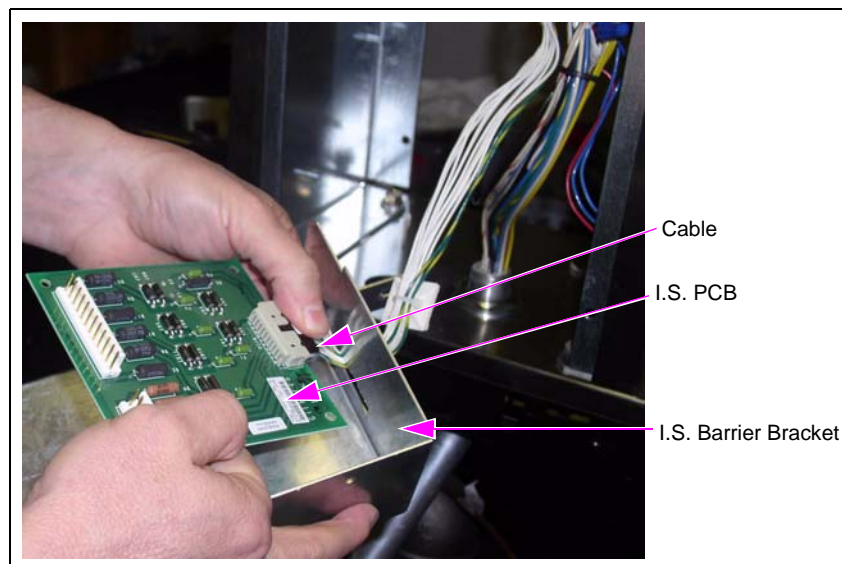



- 7 Install the PCB in the new security box, using the four 3 mm screws (Q12845-34) provided in the kit. Ensure that the connectors are oriented in the same direction as shown in [Figure 6](#).

**Figure 6: Installing the I.S. PCB**

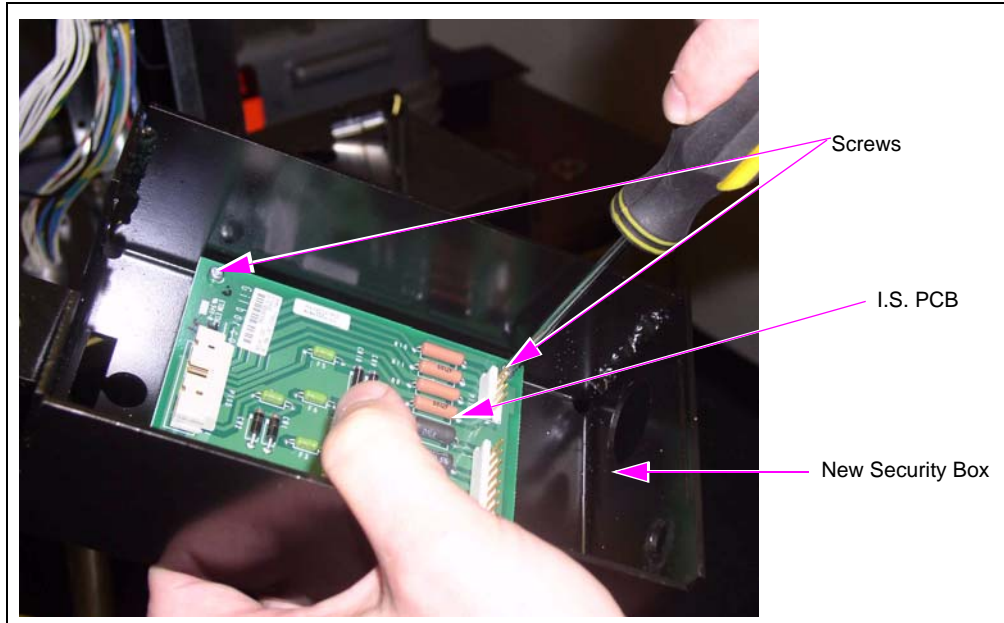

- 8 Mount two conduit washers on the top of the conduit hole and then place the security box on the conduit hole (see [Figure 7](#)).  
*Note: A very light coating of grease will help hold the washers in position during reinstallation.*

**Figure 7: Mounting Washers on the Top of the Conduit Hole**

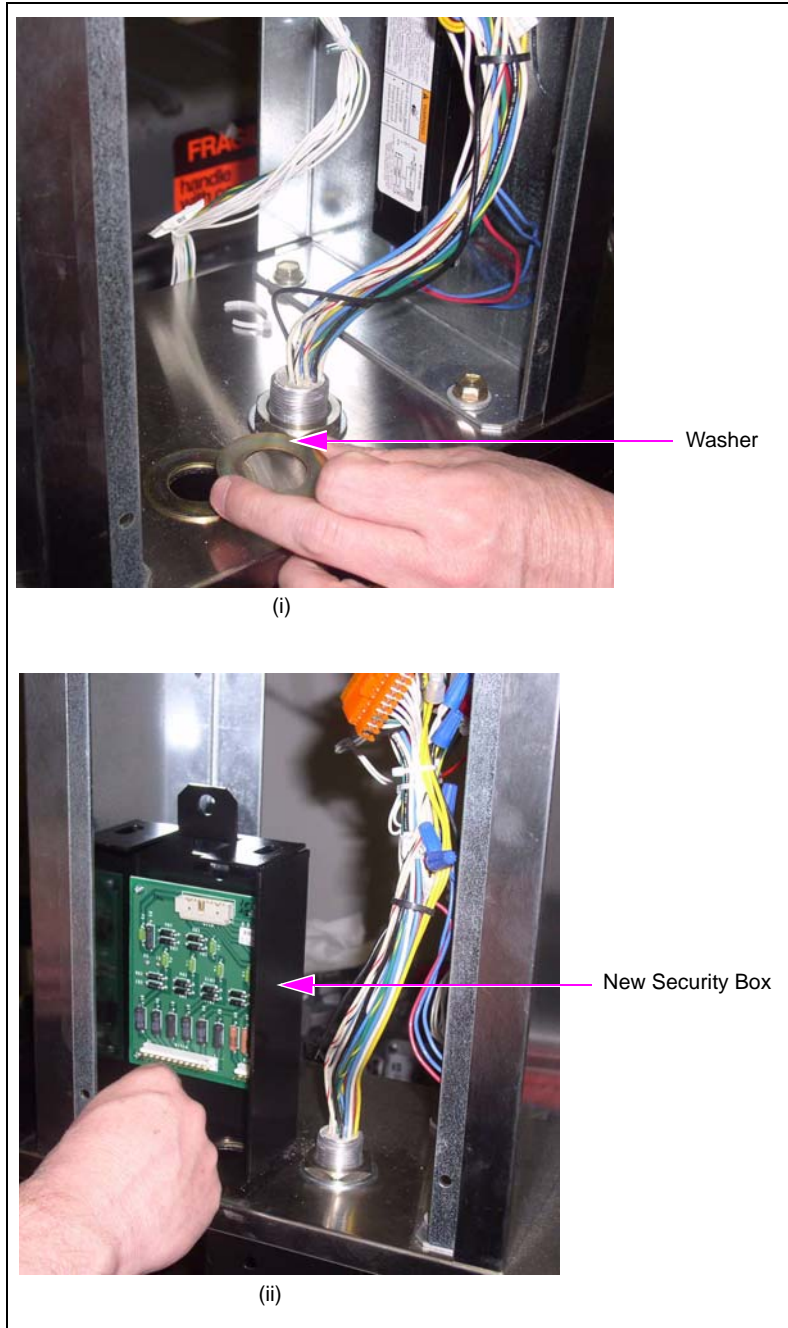



- 9 Reinstall the screw at the bottom of the security box (see [Figure 8](#) and [Figure 9](#)).

**Figure 8: Reinstalling the Screw**

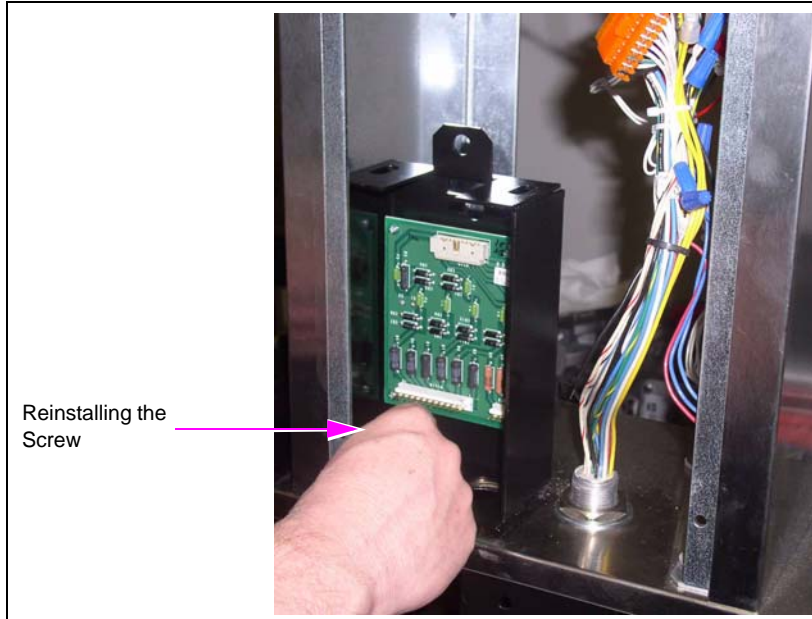

- 10 Feed the cable and conduit back up the conduit hole and through the conduit nut. Secure the conduit nut tightly at the top and bottom. Reconnect the cables (see [Figure 9](#)).

**Figure 9: Routing the Cables and Conduit**

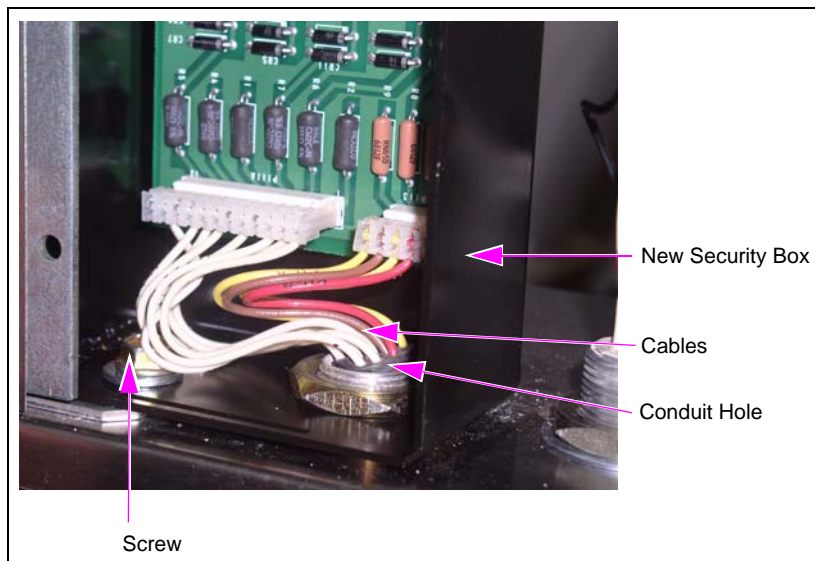

- 11 Slip the cable snap bushing over the wires on the top cable. Feed the cable into the hole at the rear of the security box and push the cable snap bushing into the round portion of the hole. Reconnect the cable to the PCB (see [Figure 10](#)).

**Figure 10: Routing the Cable Snap Bushing through the Cable**

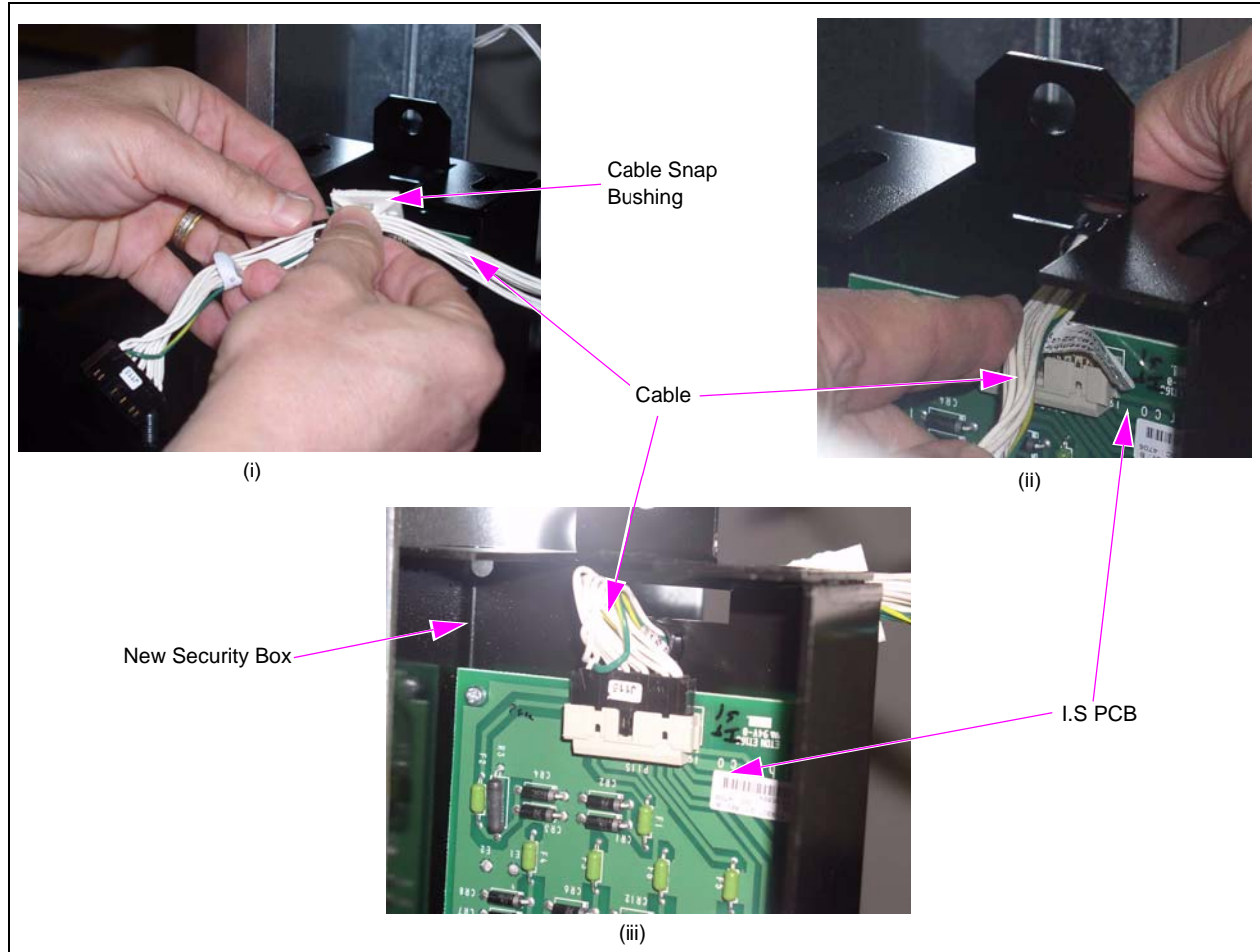

- 12 Affix the Patent Pending label to the outside of the security cover (see [Figure 11](#)).
- 13 Slide the security cover onto the security box (see [Figure 11](#)).

**Figure 11: Installing the Security Cover**

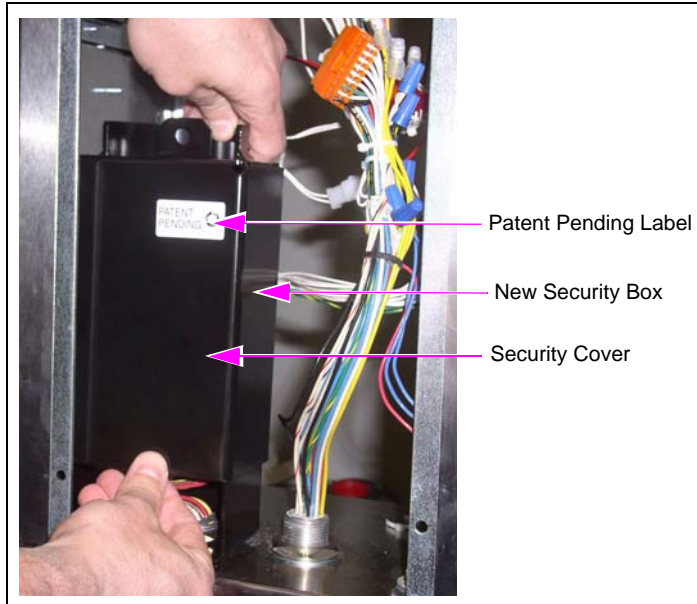

- 14 Secure the box using a hockey puck style lock (not provided in the kit). To lock, start with the key in the vertical position. When the key has been pushed almost all the way, rotate to the horizontal position. Remove the key in the vertical position (see [Figure 12](#)).

*Note: Practice with the lock prior to installing on the unit. Note the closed and locked position and ensure that the lock is fully locked before removing the key.*

**Figure 12: Installing the Lock**

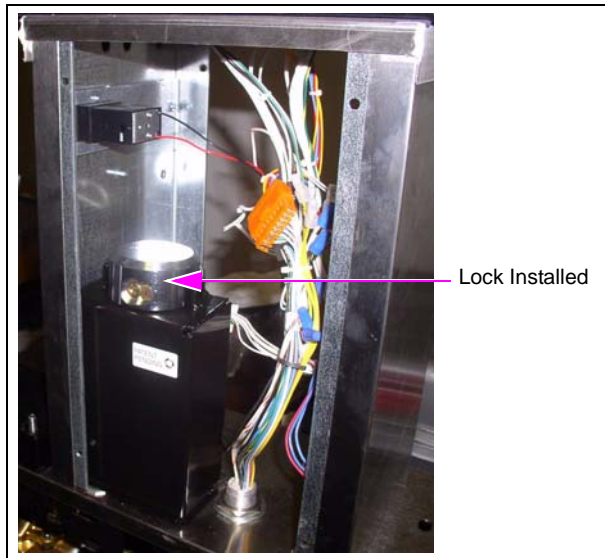

- 15 Reinstall the panel that covers the I.S. part (neck) of the unit (see [Figure 13](#)).

**Figure 13: Reinstalling the Panel and Lower Door**

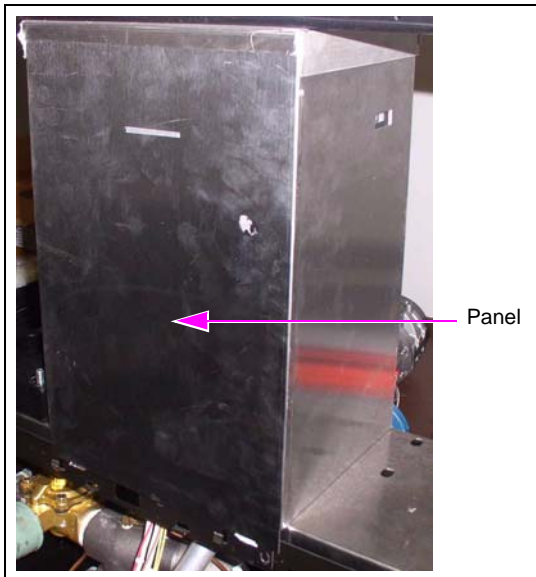

**16** Reinstall the lower door.

**17** Power up the unit and verify proper operation of the dispenser.

The installation of the Legacy Ultra-Hi I.S. Barrier Security Kit (M09286K001) is complete.



*Legacy® is a registered trademark of Gilbarco Inc. Phillips® is a registered trademark of The Phillips Screw Co. Ultra-Hi™ is a trademark of Gilbarco Inc.*



© 2008 Gilbarco Inc.  
7300 West Friendly Avenue · Post Office Box 22087  
Greensboro, North Carolina 27420  
Phone (336) 547-5000 · <http://www.gilbarco.com> · Printed in the U.S.A.  
MDE-4803 Legacy® Ultra-Hi™ I.S. Barrier Security Kit (M09286K001) Installation Instructions · December 2008