



## Introduction

### Purpose

This document provides instructions to install the TopKAT™ Fuel Management System on an Atlas™ 9800A unit, using the following upgrade kits:

- M08355K001
- M08355K002PBO

### Intended Users

This document is intended for Gasboy®-certified Authorized Service Contractors (ASCs) and Customer Specified Contractors (CSCs).

### Table of Contents

Topic	Page
<a href="#">Introduction</a>	1
<a href="#">Important Safety Information</a>	3
<a href="#">Installing the Kit</a>	5

### Required Tools

The following tools are required for the installation of the kit:

- Phillips® screwdriver
- Flat Blade screwdriver
- 1/4" Socket Set

## Parts List

The following table lists the parts included in the kits.

Item	Description	Part Number	Quantity	
			M08355K001	M08355K002PBO
1	Top Cover SST	022476	1	-
	Top Cover Painted Black	022494PBO	-	1
2	Nut 8-32	Q12068-03	4	4
3	Gasket	M07800B001	2	2
4	Base	003119	1	1
5	Bolt 1/4-20 X 5/8	K14830	8	8
6	1/4" Lock Washer	K73278-29	8	8
7	1/4" Flat Washer	K65235-20	8	8
8	AC Cable	C06816	1	1
9	Signal Cable	C06829	1	1
10	Bushing	K85071 -23	1	1
11	PCB Kit	C06483	See Note	See Note

*Note: C06483 Field Retrofit Kit - PCB485 option may be required if it is not already supplied in the unit. The TopKAT model must be ordered as a separate line item.*

## Related Documents

Document Number	Title	GOLD Library
MDE-4319	TopKAT Installation Manual	Gasboy Series 1000/Fleetkey & TopKAT

## Warranty

For information on warranty, refer to MDE-4255 Gasboy's Warranty Policy Statement. If you have any warranty-related questions, contact Gasboy's Warranty Department at its Greensboro location.

# Important Safety Information

This section introduces the hazards and safety precautions associated with installing, inspecting, maintaining or servicing this product. Before performing any task on this product, read this safety information and the applicable sections in this manual, where additional hazards and safety precautions for your task will be found. Fire, explosion, electrical shock or pressure release could occur and cause death or serious injury, if these safe service procedures are not followed.

## Preliminary Precautions

You are working in a potentially dangerous environment of flammable fuels, vapors, and high voltage or pressures. Only trained or authorized individuals knowledgeable in the related procedures should install, inspect, maintain or service this equipment.

## Emergency Total Electrical Shut-Off

The first and most important information you must know is how to stop all fuel flow to the pump/dispenser and island. Locate the switch or circuit breakers that shut off all power to all fueling equipment, dispensing devices, and Submerged Turbine Pumps (STPs).

**⚠ WARNING**

 The EMERGENCY STOP, ALL STOP, and PUMP STOP buttons at the cashier's station WILL NOT shut off electrical power to the pump/dispenser. This means that even if you activate these stops, fuel may continue to flow uncontrolled.

 You must use the TOTAL ELECTRICAL SHUT-OFF in the case of an emergency and not the console's ALL STOP and PUMP STOP or similar keys.

## Total Electrical Shut-Off Before Access

Any procedure that requires access to electrical components or the electronics of the dispenser requires total electrical shut off of that unit. Understand the function and location of this switch or circuit breaker before inspecting, installing, maintaining, or servicing Gasboy equipment.

## Evacuating, Barricading and Shutting Off

Any procedure that requires access to the pump/dispenser or STPs requires the following actions:



- An evacuation of all unauthorized persons and vehicles from the work area
- Use of safety tape, cones or barricades at the affected unit (s)
- A total electrical shut-off of the affected unit (s)

## Read the Manual

Read, understand and follow this manual and any other labels or related materials supplied with this equipment. If you do not understand a procedure, call a Gasboy Authorized Service Contractor or call the Gasboy Service Center at 1-800-444-5529. It is imperative to your safety and the safety of others to understand the procedures before beginning work.

## Follow the Regulations

Applicable information is available in National Fire Protection Association (NFPA) 30A; *Code for Motor Fuel Dispensing Facilities and Repair Garages*, NFPA 70; *National Electrical Code (NEC)*, Occupational Safety and Hazard Association (OSHA) regulations and federal, state, and local codes. All these regulations must be followed. Failure to install, inspect, maintain or service this equipment in accordance with these codes, regulations and standards may lead to legal citations with penalties or affect the safe use and operation of the equipment.

## Replacement Parts

Use only genuine Gasboy replacement parts and retrofit kits on your pump/dispenser. Using parts other than genuine Gasboy replacement parts could create a safety hazard and violate local regulations.

## Safety Symbols and Warning Words

This section provides important information about warning symbols and boxes.

### Alert Symbol



This safety alert symbol is used in this manual and on warning labels to alert you to a precaution which must be followed to prevent potential personal safety hazards. Obey safety directives that follow this symbol to avoid possible injury or death.

### Signal Words

These signal words used in this manual and on warning labels tell you the seriousness of particular safety hazards. The precautions below must be followed to prevent death, injury or damage to the equipment:



**DANGER:** Alerts you to a hazard or unsafe practice which will result in death or serious injury.



**WARNING:** Alerts you to a hazard or unsafe practice that could result in death or serious injury.



**CAUTION** with Alert symbol: Designates a hazard or unsafe practice which may result in minor injury.

**CAUTION** without Alert symbol: Designates a hazard or unsafe practice which may result in property or equipment damage.

## Working With Fuels and Electrical Energy

### Prevent Explosions and Fires

Fuels and their vapors will explode or burn, if ignited. Spilled or leaking fuels cause vapors. Even filling customer tanks will cause potentially dangerous vapors in the vicinity of the dispenser or island.

### No Open Fire



Open flames from matches, lighters, welding torches or other sources can ignite fuels and their vapors.



### No Sparks - No Smoking

Sparks from starting vehicles, starting or using power tools, burning cigarettes, cigars or pipes can also ignite fuels and their vapors. Static electricity, including an electrostatic charge on your body, can cause a spark sufficient to ignite fuel vapors. Every time you get out of a vehicle, touch the metal of your vehicle, to discharge any electrostatic charge before you approach the dispenser island.

### Working Alone

It is highly recommended that someone who is capable of rendering first aid be present during servicing. Familiarize yourself with Cardiopulmonary Resuscitation (CPR) methods, if you work with or around high voltages. This information is available from the American Red Cross. Always advise the station personnel about where you will be working, and caution them not to activate power while you are working on the equipment. Use the OSHA Lockout/ Tagout procedures. If you are not familiar with this requirement, refer to this information in the service manual and OSHA documentation.

### Working With Electricity Safely

Ensure that you use safe and established practices in working with electrical devices. Poorly wired devices may cause a fire, explosion or electrical shock. Ensure that grounding connections are properly made. Take care that sealing devices and compounds are in place. Ensure that you do not pinch wires when replacing covers. Follow OSHA Lockout/Tagout requirements. Station employees and service contractors need to understand and comply with this program completely to ensure safety while the equipment is down.

### Hazardous Materials

Some materials present inside electronic enclosures may present a health hazard if not handled correctly. Ensure that you clean hands after handling equipment. Do not place any equipment in the mouth.

#### WARNING

The pump/dispenser contains a chemical known to the State of California to cause cancer.

#### WARNING

The pump/dispenser contains a chemical known to the State of California to cause birth defects or other reproductive harm.

## In an Emergency

### Inform Emergency Personnel

Compile the following information and inform emergency personnel:

- Location of accident (for example, address, front/back of building, and so on)
- Nature of accident (for example, possible heart attack, run over by car, burns, and so on)
- Age of victim (for example, baby, teenager, middle-age, elderly)
- Whether or not victim has received first aid (for example, stopped bleeding by pressure, and so on)
- Whether or not a victim has vomited (for example, if swallowed or inhaled something, and so on).

#### WARNING



Gasoline ingested may cause unconsciousness and burns to internal organs. Do not induce vomiting. Keep airway open. Oxygen may be needed at scene. Seek medical advice immediately.

#### WARNING



Gasoline inhaled may cause unconsciousness and burns to lips, mouth and lungs. Keep airway open. Seek medical advice immediately.

#### WARNING



Gasoline spilled in eyes may cause burns to eye tissue. Irrigate eyes with water for approximately 15 minutes. Seek medical advice immediately.

#### WARNING



Gasoline spilled on skin may cause burns. Wash area thoroughly with clear water. Seek medical advice immediately.

**IMPORTANT:** Oxygen may be needed at scene if gasoline has been ingested or inhaled. Seek medical advice immediately.

### Lockout/Tagout

Lockout/Tagout covers servicing and maintenance of machines and equipment in which the unexpected energization or start-up of the machine(s) or equipment or release of stored energy could cause injury to employees or personnel. Lockout/Tagout applies to all mechanical, hydraulic, chemical or other energy, but does not cover electrical hazards. Subpart S of 29 CFR Part 1910 - Electrical Hazards, 29 CFR Part 1910.333 contains specific Lockout/ Tagout provision for electrical hazards.

# Installing the Kit

Figure 1: Exploded View of the Kit Assembly (M08355K001 or M08355K002PBO)

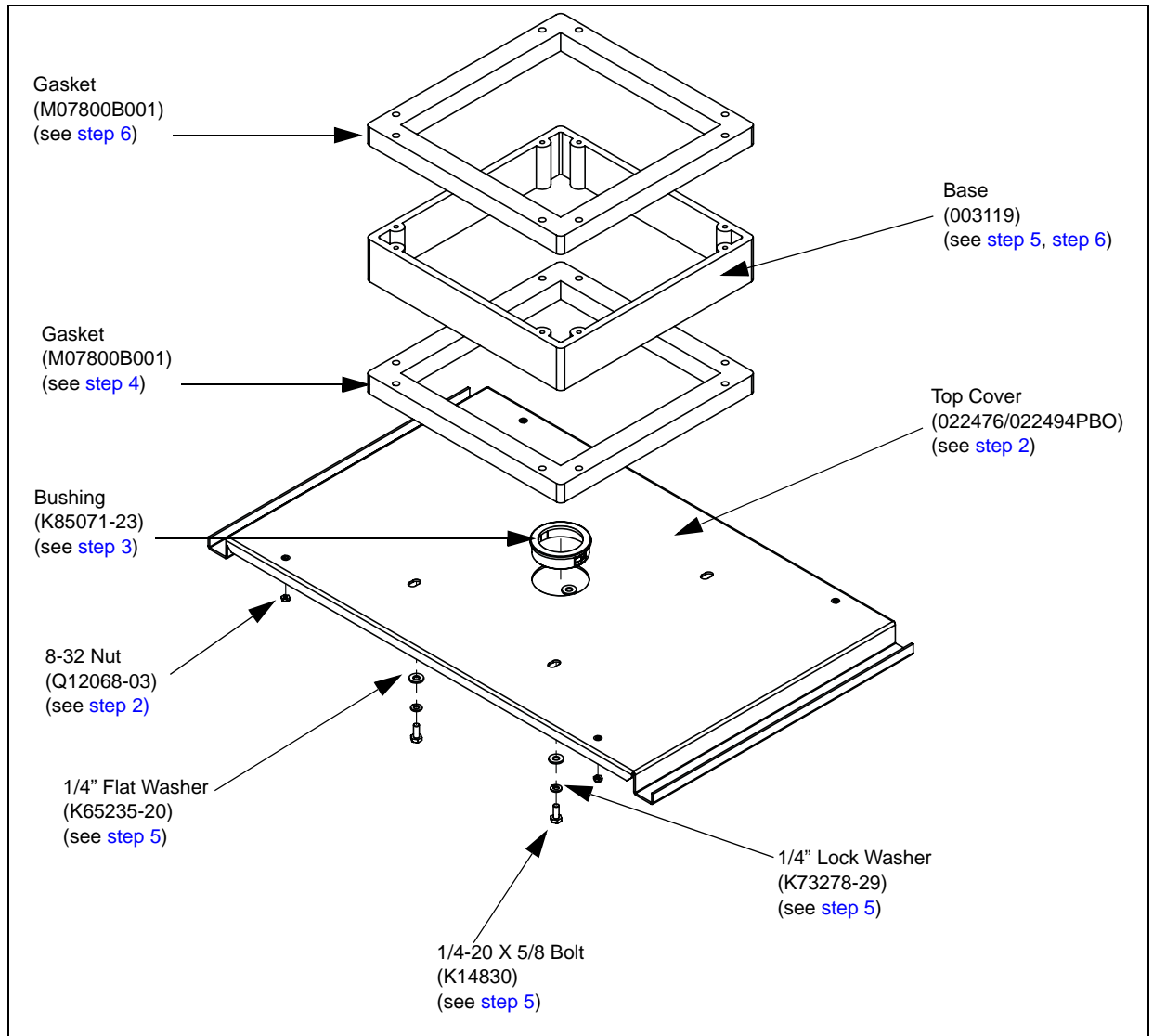

To install either of the kits, M08355K001 or M08355K002PBO, proceed as follows:

- 1 Remove the existing top cover.
- 2 Use the supplied 8-32 nuts to install the new Top Cover.
- 3 Install the Bushing (K85071-23) in the center hole (from outside).
- 4 Attach the Gasket (M07800B001) to the Top Cover position, aligning the 8 MTG holes and adhesive side to the Top Cover.

## Installing the Kit

---

- 5 Use the four 1/4-20 Bolts, Lock Washers and Flat Washers to install the Support Base from inside the unit.
- 6 Attach the Gasket (M07800B001) to the top surface of the Support Base, aligning the 8 MTG holes and adhesive side to the Support Base.
- 7 Install the cables and the TopKAT to the unit. Refer to MDE-4319 TopKAT Installation Manual for instructions.  
*Note: Four 1/4-20 bolts, Lock washers and Flat washers are provided to install the TopKAT.*

*Atlas™ and TopKAT™ are trademarks of Gasboy International. Gasboy® is a registered trademark of Gilbarco Inc. Phillips® is a registered trademark of The Phillips Screw Co.*



© 2008 GASBOY  
7300 West Friendly Avenue · Post Office Box 22087  
Greensboro, North Carolina 27420  
Phone 1-800-444-5529 · <http://www.gasboy.com> · Printed in the U.S.A.  
MDE-4733 TopKAT™ Upgrade Kit For Atlas™ 9800A · March 2008