

## INSTALLATION INSTRUCTIONS FOR MODEL 215A FRONT LOAD VAPOR RECOVERY KIT 032137

This instruction sheet covers the instruction of the Model 215A Front Load Balanced System Vapor Recovery Kit. If you are installing another manufacturer's vapor recovery system, you may need to modify the nozzle boot using the **Modify Nozzle Boot** instruction below. Vapor Recovery Kit, 032137 contains the following:

Item	Part No.	Description	Item	Part No.	Description
1	032671	HHR Kit, Clamp and Reel, VR (GY Prem)	11	064560	Swivel, Hose, 3/4, #36S
2	063816	Support Bar, HHR	12	038502	Nozzle, Emco VR A4005 Stg II
3	017930	Caplug-1-1/2 Sq. Tube	13	030301	Hose, GY Max Prem, 7.5'
4	051956	Screw, 5/16-18x2, SS	14	066817	Splitter, Emco, 4041-02
5	068079	Washer, 5/16, SS	15	030407	Hose, 3/4" HW UL 1.5
6	068874	Washer, Lock, Std Spring, 5/16, SS	16	017270	Bushing, 3/4 x 1
7	056924	Spacer, HHR	17	044007	Breakaway Coupling, Coax OPW66CL0250
8	013250	Bolt, 5/16 Mach Anchor HHR	18	030303	Hose, GY Max Prem 4.5'
9	047219	Plug Button, 7/8	19	032138	Instructions (this sheet)
10	038605	Nut, 5/16-18 Hex Keys	20	035282	Warnings and Safeguards Sheet

### IMPORTANT:

Always use a UL-classified gas and oil resistant pipe compound on all male pipe threads when assembling these components. All references to pipe compound in these instructions imply UL-classified pipe compound.

1. Read all instructions before beginning. A separate instruction sheet is packed with the EMCO Wheaton splitter manifold, which is required for mounting this component. Also read and follow all precautions regarding remote dispensers and pumps on the *Warning and Safeguards Sheet, 035282*, included in this kit.
2. Turn off power to the dispenser at the breaker and activate emergency shutoff valve.
3. Mount the splitter per the EMCO Wheaton instructions.

### Assemble Product Jumper Hose

Assemble 3/4" x 1" bushing (017270) to dispenser outlet. Assemble 3/4" swivel (064560) to one end of the 3/4" jumper hose (030407). Assemble fixed end of jumper hose to bushing on dispensing outlet, and the swivel end at the splitter port labeled **FUEL**.

### Mount Hose Retriever

1. Assemble clamp & reel assembly (Item 1) to support post (Item 2) with items 4, 5 & 6.
2. Install reel and post assembly to side of unit with Items 4, 5, 6, 7, & 10, and leave loose. Item 7 mounts between post and side panel.
3. Making sure the support post is plumb, mark and drill a 5/8" dia. x 1-3/4" deep hole in island. Install anchor bolt (item 8) into island surface. Install items 4, 5, and 6.
4. Tighten all hardware. Plug hole in post with item 9.

### Modify Nozzle Boot

If using a long spout vapor-recovery nozzle, it may be necessary to remove the nozzle restraint bracket and the lock.

## Mount Hose to Retriever

1. Lubricate the new inverted hose threads and O-rings with a lithium-based grease and thread the hose onto the pump. Tighten the hose/pump connection. Do not use pipe thread compound or Teflon tape on hose connection.
2. With white grease, lubricate the threads on the opposite end of the hose and install the breakaway. Lubricate and thread the second section on the hose into the breakaway.
3. Thread nozzle onto the hose and tighten. *NOTE: For additional installation information, refer to specific procedures supplied with the breakaway and nozzle.*
4. Assemble clamp to hose and position so that hose does not touch ground when nozzle is hung in nozzle boot. Pull out hose and check operation of the retriever and the orientation of the nozzle.

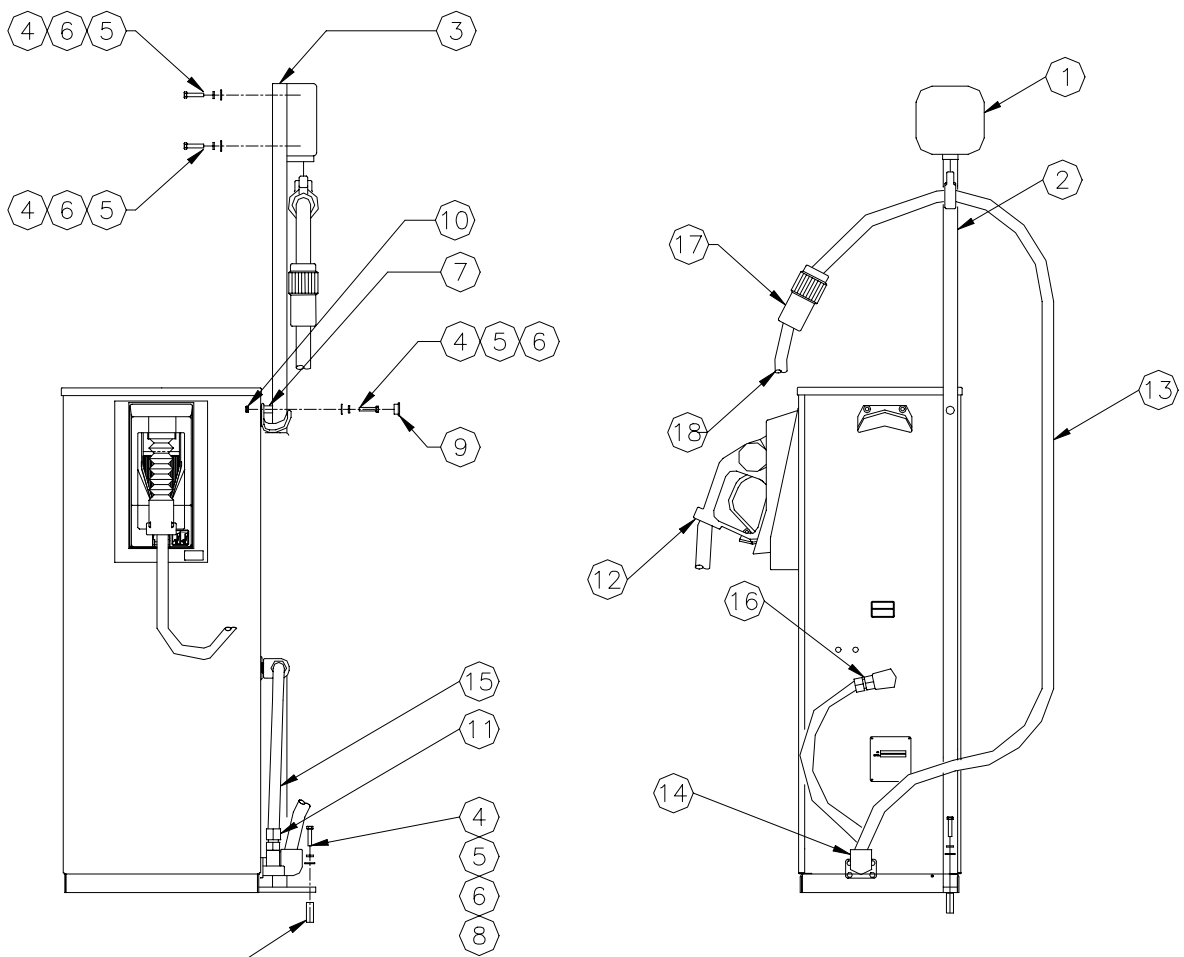

DRILL HOLE 5/8"  $\phi$  X 1-3/4" DEEP IN CONCRETE