

Installation Instructions

Purpose Of This Document

This document provides information on how to install K35164 Meter Seal Top Replacement Kit on Gilbarco A and B meters built before 1986.

Read NFPA 30A And NFPA 70



Before installing the equipment, the installer must read, understand and follow this manual, NFPA 30A (The U.S. Automotive and Marine Service Station Code) and NFPA 70 (The U.S. National Electric Code) and applicable federal, state and local codes and regulations. Failure to do so may adversely affect the safe use and operation of the equipment.

Recommended Tools And Equipment

Gilbarco recommends the following tools to install K35164 Meter Seal Top Replacement Kit:

- Slotted head screwdriver
- 1/4" and 1/2" drive socket sets
- U.S. open-end wrench set

Recommended Manual

Gilbarco recommends the following manual, along with MDE-2115, to install the Meter Seal Top Replacement Kit:

- MDE-2531 Pump and Dispenser Service Manual

Parts List K35164

Description	Kit/Part #	Quantity
Gasket, Upper Bearing	K85526-01	1
O-ring 9/32	N16891-24	1
Screw, Seal Cap	K93293	3
O-ring Sleeve	Q11970-01	1
Seal Wire	K14195	1
O-ring Removing Tool	K93422	1

Safety



Alert Symbol

This is a standard alert symbol. When you see this symbol, with the following signal words, be alert to the potential for personal injury. See MDE-2531 Pump and Dispenser Service Manual for information.

Signal Words

These signal words alert you to important safety hazards.

DANGER
<p>The hazard or unsafe practice will result in severe injury or death</p>

WARNING
<p>The hazard or unsafe practice could result in severe injury or death</p>

CAUTION
<p>The hazard or unsafe practice could result in minor injury</p>

Installation Instructions

Preparation

- 1 Read all instructions before beginning.
- 2 Follow all safety precautions.

 - Barricade area.
 - Do not allow vehicles or unauthorized people in work area.
 - Do not smoke or have open flames in work area.
 - Do not use electric power tools in work area.
 - Wear protective gear (safety glasses, gloves) in work area.
- 3 Record all electronic and mechanical totals. Isolate unit at distribution box.
- 4 On pumps only, turn off all power at circuit breaker.
- 5 Remove lower door and, on dispensers only, close and test all shear valves. Place nozzle(s) into approved container to drain and bleed pressure. Some residual pressure may remain. See MDE-2531 for test procedures.
- 6 Turn off all power to unit including unit lights. Turn off associated STP power. Use system circuit breakers. Multiple disconnects may be required.
- 7 Turn off system battery by pressing CLEAR and ENTER on the manager keypad for modular units. For premodular units, the system battery turns off with the main power.

Removing Meter

- 1 Remove pulser on electronic unit or gear cover on mechanical unit from meter drive shaft. See Figure 1.



- 2 Remove discharge line flange and inlet flange bolts. See Figure 1.

- 3 Support meter while removing bracket bolts and remove meter from unit. See Figure 1.

- 4 Support end of shaft and remove pin then remove gear(s). See Figure 1.

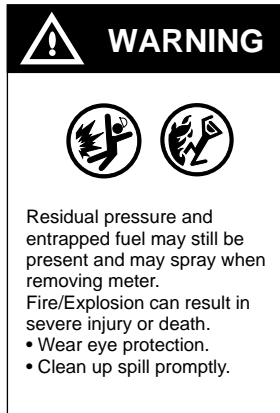
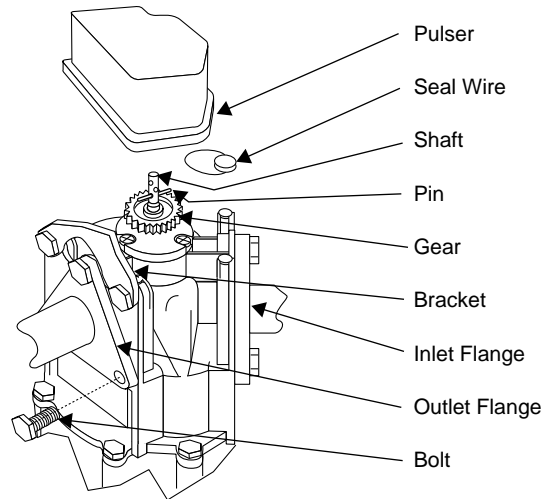

Figure 1



Removing Seal and O-ring

- 1 Lightly sand burrs on shaft near holes.
- 2 Disassemble seal cap. Do not scratch shaft. See Figure 2.
- 3 Remove seal gasket and clean the sealing surfaces of the seal ring cap and meter cover. Do not scratch the sealing surfaces while cleaning. See Figure 2.

Figure 2

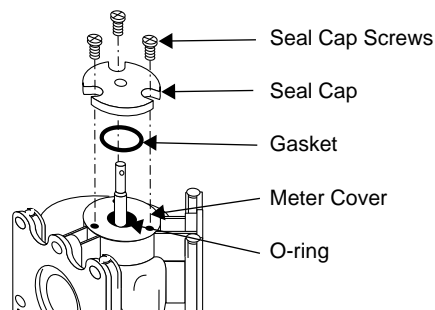
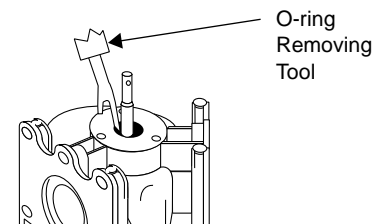

Figure 3



- 4 Using the O-ring removing tool, remove O-ring from meter. Do not scratch shaft. See Figure 3.

Installing New Seal and O-ring

- 1 Place O-ring installation sleeve over shaft. If used on mechanical unit, cut 1" from the large end before placing sleeve over shaft. See Figure 4. Now cover the sleeve with silicon grease.
- 2 Slide O-ring down the sleeve onto the shaft. Do not twist or roll O-ring. See Figure 4.

Figure 4

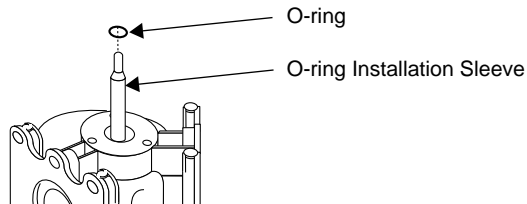

- 3 Install new gasket with seal cap. See Figure 2.
- 4 Install new screws. See Figure 2. See MDE-2531 for torques.
- 5 Reinstall gear(s) and then pin. See Figure 1.

Reinstalling Meter to Unit

- 1 Inspect and clean inlet and discharge line mounting surfaces.
- 2 Install new inlet and discharge line O-rings.
- 3 Bolt meter to inlet and discharge flanges. See MDE-2531 for torques.
- 4 Bolt meter to mounting brackets. See Figure 1.
- 5 Replace pulser or gear cover and associated hardware. See Figure 1.
- 6 On dispensers, open shear valve.
- 7 Turn on unit and on dispensers STP power. In the distribution box, place unit in normal operation.



- 8 Purge air and check for leaks. See MDE-2531.
- 9 Calibrate meter. See MDE-2531.