

Purpose Of This Document

This manual provides the information to assemble and install Lighted Canopy Conduit Kits on The Advantage® Series.

| Kit Number | Where Used |
|-------------------|-------------------|
| K35497 | Dispensers |
| K93757 | Pumps |

Recommended Tools

- Screwdriver, Phillips and Standard
- Wrench, Crescent, Medium
- Wrench, Pipe or Channel Lock, Medium
- Wrench Set, Standard Open-end (U.S.)

Read NFPA 30A and NFPA 70



Before installing the equipment, the installer must read, understand and follow this manual, NFPA 30A and NFPA 70 and applicable federal, state and local codes and regulations. Failure to do so may adversely affect the safe use and operation of the equipment.

Related Documents



Refer to the following manuals for additional information:

- MDE-2530 The Advantage Site Prep/Hardware Installation Manual
- MDE-2531 The Advantage Start-Up/Service Manual
- PT-1728 The Advantage Illustrated Parts Manual

Safety Information



Alert Symbol

This is a standard alert symbol. When you see this symbol, along with the following signal words, be alert to the potential for personal injury.

Signal Words

These signal words alert you to important safety hazards.

| |
|---|
|  DANGER |
| <p>The hazard or unsafe practice will result in severe injury or death.</p> |

| |
|--|
|  WARNING |
| <p>The hazard or unsafe practice may result in severe injury or death.</p> |

| |
|--|
|  CAUTION |
| <p>The hazard or unsafe practice could result in minor injury.</p> |

Parts List

K35497 and K93757

Except for the conduit (Item 4), the parts in both kits are the same.

| Item Number | Description | Part Number | Qty. |
|-------------|---|----------------------------|--------------|
| 1 | Nipple and Wire Assembly | R19101-G2 | 1 |
| 2 | Elbow 1/2" x 90 degree FxF | K42428 | 2 |
| 3 | Nipple 1/2" x 1-1/8" | R11976-39 | 1 |
| 4 | Conduit (for dispensers; K35497 kit only) or Conduit (for pumps; K93757 kit only) | T18027 or R12579-120 | 1 or 1 |
| 5 | Elbow 1/2" x 90 degree FxM | K42448 | 1 |
| 6 | Union | Q10016-04 | 1 |
| 7 | Pipe Clamp | N23644-G1 | 1 |
| 8 | Screw | K02447 | 1 |
| 9 | Washer, Lock 1/4" | K50773 | 1 |
| 10 | Washer 1/4" | K14056 | 1 |
| 11 | Conduit Nut 1/2" | K89681 | 2 |
| 12 | Conduit Washer 1/2" | N16599-59 | 2 |
| 13 | Wire Connector | Q10158-01 | 2 |
| 14 | Wire Terminal | K67087-64 | 1 |

Installation

Before You Begin



- 1 Read all instructions before beginning.
- 2 Follow all of the following safety precautions.
 - Barricade the work area.
 - Do not allow vehicles or unauthorized people in work area.
 - Do not smoke or have open flames in work area.
 - Do not use power tools in work area.
 - Wear protective gear while performing this procedure.
- 3 Record all electronic and mechanical totals.
- 4 Isolate each pump at distribution box.
- 5 For both pumps and dispensers, turn off all power to unit including unit lights. Use system circuit breakers. Multiple disconnects may be required. For dispensers also turn off associated STP power and turn off power to all dispensers on same isolation relay if used.

Removing Existing Hardware

- 1 Remove front lower panel on Side A, meaning side with junction box.
- 2 Remove column sheathing on right (as you face Side A).
- 3 Remove end of upper housing cover and remove knockout from upper housing cover. (Refer to “Figure 1 – Upper Housing” on page 5).
- 4 Remove junction box cover and 1/2inch pipe plug (on top right of junction box). Refer to “Figure 2 – Routing Wires and Conduit on The Advantage” on page 5.

Assembling conduit and wire assembly

Note: Assemble conduit outside of unit.

- 1 Place a washer and a nut (items 11 and 12) on both ends of the conduit and wire assembly (Item 1).
- 2 Route wires through K42428 elbow (Item 2). Attach elbow to assembly.
- 3 Route wires through nipple (Item 3). Attach nipple on other end of elbow in assembly.
- 4 Route wires through conduit (Item 4).
- 5 Route wires through K42448 elbow (Item 5). Attach to bended end of conduit.

Installing The Conduit

- 1 Attach female-threaded side of union to junction box hole where pipe plug was removed earlier.

- 2** Remove pipe clamp bracket. Place assembly in column with 90° bend routed through bottom access in right column.
- 3** Attach male-threaded side of union (Item 6) to K42448 elbow (Item 5) on conduit wire assembly. Route wires through union.
- 4** Feed wires into junction box.
- 5** Tighten all connections.
- 6** Replace pipe clamp bracket.
- 7** Attach conduit assembly to pipe clamp bracket using pipe clamp, screw, lock washer, and washer (items 7, 8, 9, 10).
- 8** Replace end cover of upper housing.
- 9** Replace column sheathing.
- 10** Install lighted canopy per manufacturer's instructions.
- 11** Make three wire connections in the junction box. Use wire joint (Item 13) to connect white and black wires. Use Item 14 (K67087-64 Terminal Ring) to connect green wire to ground lug. Check all other wiring connections and replace and secure junction box cover.
- 12** Replace lower panel.
- 13** Apply power to dispenser and STP. Check unit operation.

Figure 1 – Upper Housing

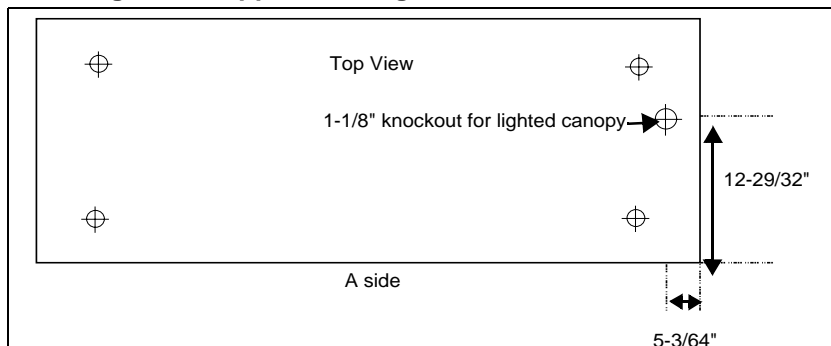
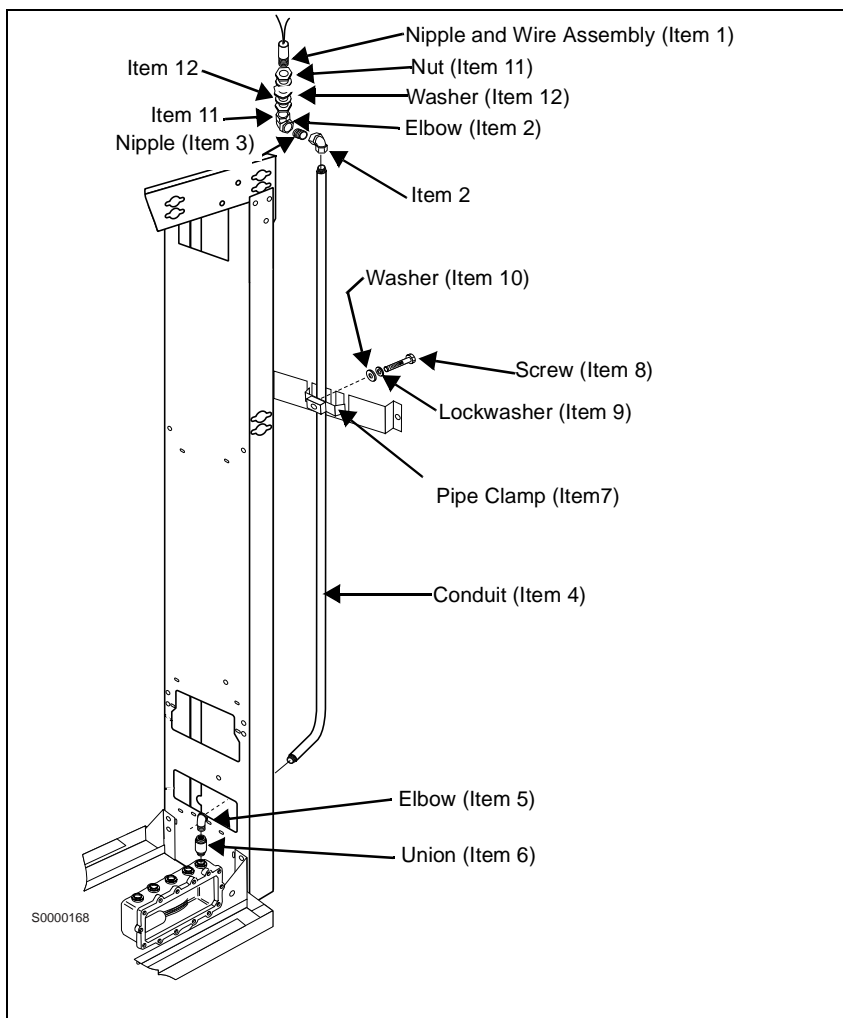

Figure 2 – Routing Wires and Conduit on The Advantage
See "Parts List" on page 2 for item number descriptions



The Advantage® is a registered trademark of Gilbarco Inc.



© 2003 Gilbarco Inc.
7300 West Friendly Avenue • Post Office Box 22087
Greensboro, North Carolina 27420
Phone (336) 547-5000 • <http://www.gilbarco.com> • Printed in the U.S.A.
MDE-2677B Kits K35497 and K93757 Lighted Canopy Conduit For The Advantage® Series • June 2003