

# Installation Instructions

## 6" MAXXUM – 5-WIRE MALE CONNECTOR KIT

The following defined terms are used throughout this literature to bring attention to the presence of hazards of various risk levels, or to important information concerning the life of the product.

**DANGER**

Indicates presence of a hazard which *will* cause *severe* personal injury, death or substantial property damage if ignored.

**CAUTION**

Indicates presence of a hazard which *will* or *can* cause *minor* personal injury, death or substantial property damage if ignored.

**WARNING**

Indicates presence of a hazard which *can* cause *severe* personal injury, death or substantial property damage if ignored.

**NOTICE**

Indicates special instructions on installations, operation, or maintenance which are important but not related to personal injury hazards.

### Disable the Pump

**DANGER**

**Always DISCONNECT and LOCK or TAG OUT the power before starting to service the pump.**

1. Back out the electrical yoke disconnect bolt.
2. Swing the electrical connector aside.
3. Remove the o-ring on brass yoke connector and replace with the new one provided. Lubricate o-ring with light grease, oil or petroleum jelly.
4. Remove the wiring compartment cover.
5. Remove the o-ring on the wiring compartment cover and replace with the new one provided. Lubricate o-ring with light grease, oil or petroleum based jelly.
6. Disconnect wires between male connector and pigtail.
7. Remove snap-ring located above male connector.
8. Remove male connector.
9. Tape end of male connector wire leads.
10. Insert male connector into extracta head making sure locator pin is aligned with slot in extracta head and push firmly in place. Top edge of male connector should be approximately 1.86-inch below extracta head shoulder when properly seated.
11. Insert new snap ring.
12. Remove tape from male connector and connect like colored wires of male connector to pigtail wires in wiring compartment.
13. Replace wiring compartment cover, torque 20-50 ft-lbs.
14. Swing electrical yoke back into place and tighten yoke bolt. Torque to 30-60 ft-lbs.

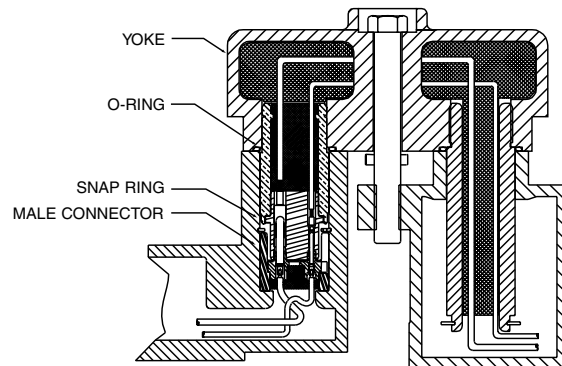
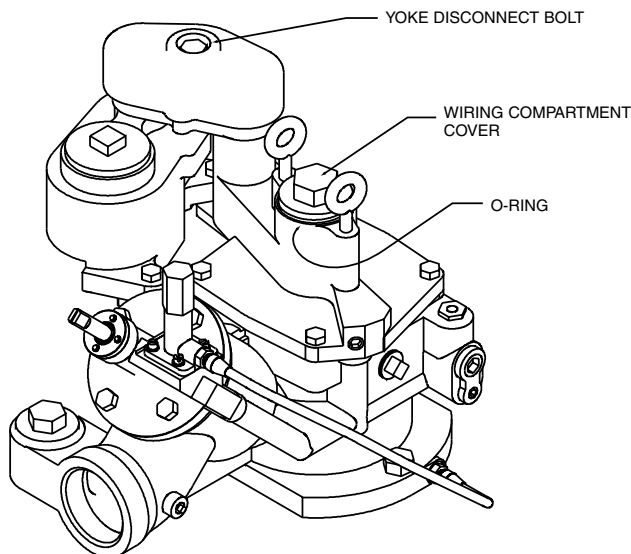

500 East 59th Street • Davenport, IA 52807 • 319-391-8600  
 Red Jacket reserves the right to make design improvements and pricing modifications as necessary and without notice.  
[www.redjacket.com](http://www.redjacket.com) Printed in USA