

## INSTRUCTION SHEET – REPLACING MERCURY SWITCH (9800A/2600A 215A/7215A FRONT LOAD MODELS)

1. Refer to the *Warnings and Safeguards* sheet (P/N 035282) included in the kit regarding precautions for the remote dispensers and pumps.
2. Remove door from pump/dispenser.
3. Lift handle to access set screw used to secure the mercury switch (see figure at right).
4. Remove set screw. It may be necessary to loosen thread lock on set screw using a heat gun. If this is necessary, follow steps 4a – 4d, which describe removal of the nozzle boot assembly so heat gun may be used a safe distance from the pump, otherwise skip to step 5.
- 4a. Disconnect the wire plugs which connect the boot assembly to the intrinsically safe barrier.
- 4b. Remove the two bolts which attach the nozzle boot assembly to the pump frame so the boot assembly may be worked on a safe distance from the pump.
- 4c. Heat the set screw with a heat gun for approximately 30 seconds, which will allow easy removal of the set screw.
5. Remove the e-ring located on the end of the mercury switch (see figure at right).
6. Slide mercury switch out.
7. Install replacement mercury switch.
8. Apply a light coat of thread lock to set screw threads
9. It is important that the set screw engages the hole in the shaft of the mercury switch (see figure below).

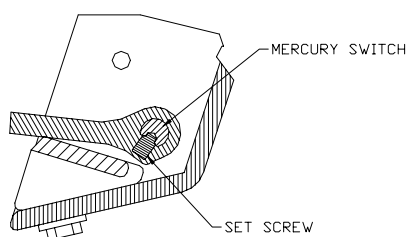

10. Reinstall e-ring on the mercury switch.

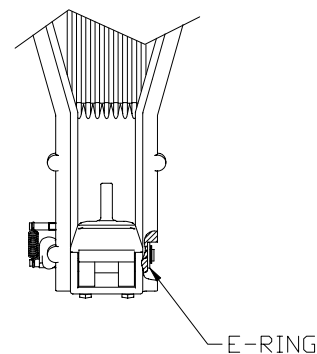
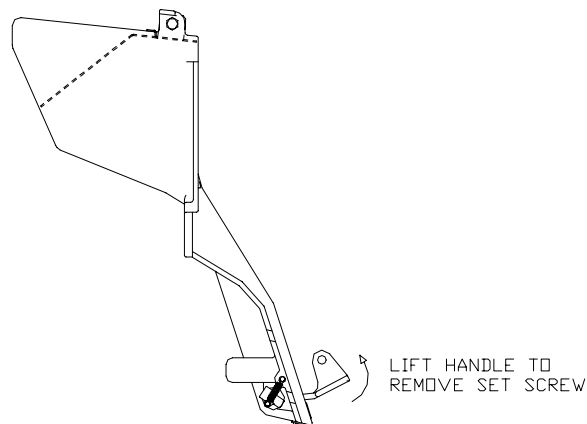

**Do not dispose of or incinerate the mercury switch.  
Return the entire switch unit for recycling to:  
Power Components  
56641 Twin Branch Dr.  
Mishawaka, IN 56545**