

TLS Overfill Alarm Light Replacement Guide

Manual No. 577014-321• Rev A

1. Turn off the electricity, tag and lockout the electrical power switch to the Overfill Alarm box.



WARNING! Electricity must be turned off to the Overfill Alarm box prior to service to avoid personal injury or death!

1. Loosen the 4 door securing clamp screws and slide all of the clamps free of the cover (Figure 1).

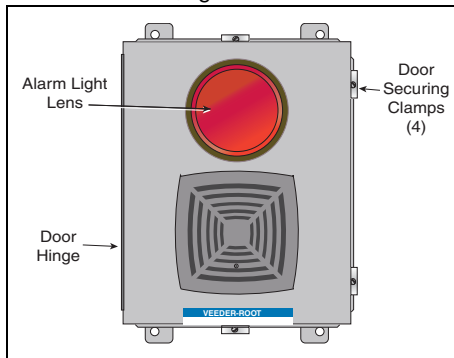

Figure 1. Overfill Alarm Box

2. Open the box door and notice the lamp socket in its mounting plate on the inside of the cover. Remove and set aside the two screws holding the lamp socket mounting plate to the inside of the door (Figure 2).

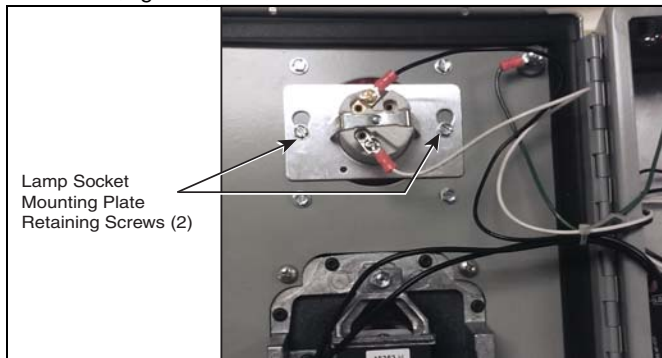

Figure 2. Remove Lamp Socket

3. Carefully remove the lamp socket mounting plate from the door as you guide the lamp bulb through the hole in the door.
4. Unscrew the old light bulb and discard it.
5. Get the replacement LED bulb from the kit# 330020-829 and screw it into the socket.
6. Carefully insert the new bulb through the hole in the door and secure the socket mounting plate to the inside of the door using the two screws removed earlier.

TEST THE REPLACEMENT BULB

Testing the Overfill Alarm Lamp - Using Ack Switch

1. Turn On power to the Overfill Alarm box and Acknowledge (Ack) Switch.

2. Depress and hold in the TEST Button on the right side of the Ack Switch box (Figure 3).

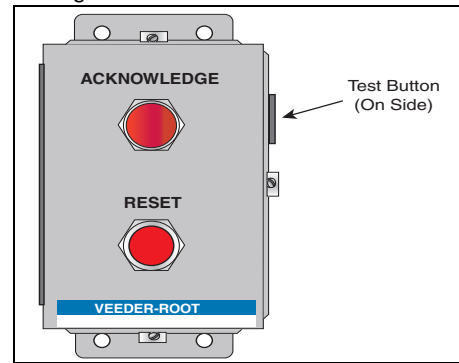

Figure 3. Test Switch Location On Ack Switch Box

3. The Overfill Alarm horn will sound immediately, and the Overfill Alarm's red light will start flashing. The horn will turn off after the preset delay time (0-60 seconds). The red light will continue to flash until the TEST button is released.

Testing the Overfill Alarm Lamp - No Ack Switch



1. With no deliveries about to begin or in progress, turn off, tag and lockout power to the console and to the Overfill Alarm box. Open the console door and locate the relay output terminals that are wired to the Overfill Alarm box. Put a jumper between these two terminals (Figure 4)..

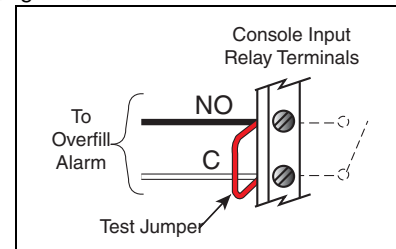



Figure 4. Lamp Test Jumper Console Connection

2. Reapply power to the first to the Overfill Alarm box and then to the console. The Overfill Alarm horn should sound immediately followed by the red Overfill Alarm light flashing.

3.   Turn Off power to the console and to the Overfill Alarm box. Remove the jumper between the Output Relay connections.
4. Close and secure the door of the console.
5. Reapply power to the console and the Overfill Alarm box.