

# INSTALLING THE SUMP OVERFLOW CHECK VALVE FOR Q SERIES SINGLE PUMPS KIT #023900

## 023900 Kit Contents

| Item | Part No. | Description                         |
|------|----------|-------------------------------------|
| 1    | 023997   | Assembly, Sump Overflow Check Valve |
| 2    | 020701   | Vent Tube                           |
| 3    | 020700   | Assembly, Vent Tube                 |
| 4    | 015191   | Bracket, Sump Overflow              |
| 5    | 020702   | Hanger, Conduit Size, 1-1/2"        |
| 6    | 051866   | Screw, 1/4-20 x 1-1/4 HHC PI        |
| 7    | 038860   | Nut, 1/4-20 Hex                     |
| 8    | 053919   | Screw, 1/4-20 x 1/2 HH Taptite      |
| 9    | 026044   | Fitting, 3/8 Elbow, Inverted Flared |
| 10   | 058021   | Grommet                             |
| 11   | 020897   | Instruction sheet (this sheet)      |

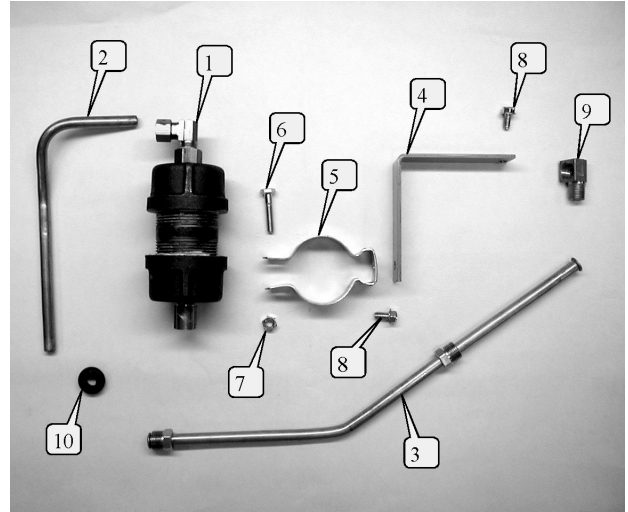

1. Turn off power to the pump. Unlock and open the doors. Trip the shear valve's poppet to prevent fuel flow into the pump.
2. Pre-assemble the conduit hanger (item 5) to the bracket (item 4) using a 1/4-20 x 1/2 Taptite screw (item 8). *(NOTE: use the hole that is 1/2" from the edge.)* (Figure 1)



**Figure 1**

3. Slide the sump over flow assembly (item 1) into the conduit hanger. Using the 1/4-20 x 1-1/4 screw (item 6) and 1/4" nut (item 7) to secure the sump over flow assembly loosely in place. (Figure 2)



**Figure 2**

4. Behind the junction box, disconnect the existing vent tube and remove the existing compression elbow in the pumping unit. Install a 3/8" inverted flared fitting (item 9) into the pumping unit where the compression elbow just been removed. Rotate the new fitting at about 35° as shown in Figure 3.

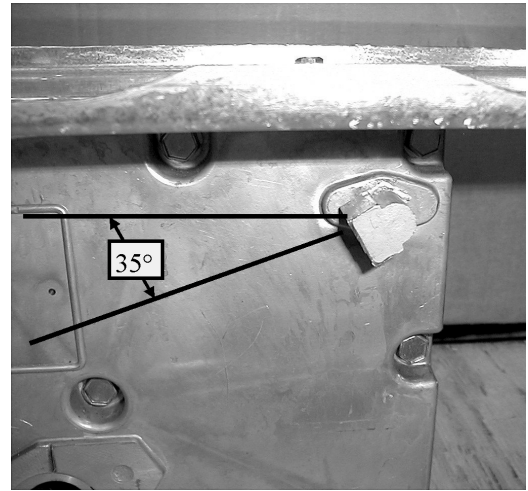

**Figure 3**

5. Install the pre-assembled unit from Step 3 onto the underside of the motor/pump platform. Using a 1/4-20 x 1/2 Taptite screw (item 8, feed through an existing hole in the platform that is close to the flange and the left side column. Secure the unit loosely. (Figure 4)



**Figure 4**

6. Connect the vent tube assembly with flared nuts (item 3) between the pumping unit's elbow and the bottom elbow of the sump overflow assembly (item 1). (Figure 5: *NOTE: Junction box removed for visibility.*)

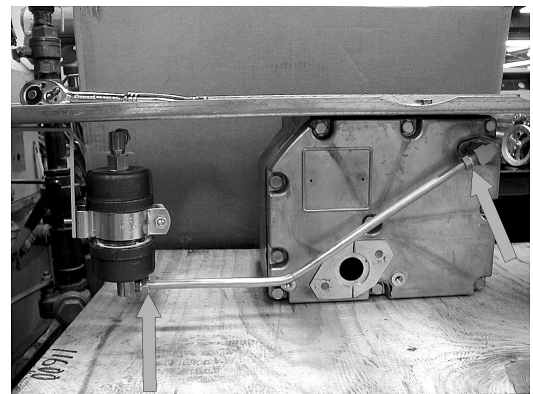

**Figure 5**

7. Install/insert the grommet (item 10) into the existing vent hole in the left side column (view from junction box side). (Figure 6)



**Figure 6**

8. Remove the compression sleeve and compression nut from the top elbow of sump overflow assembly (item 1), then pre-assemble the sleeve and nut over the vent tube as shown in Figure 7.

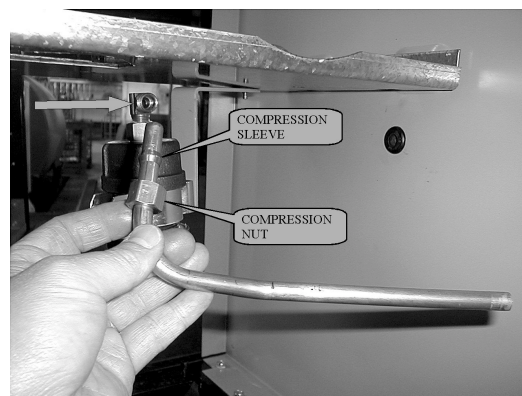

**Figure 7**

9. Connect the pre-assembled vent tube to the compression elbow and insert the other end into the grommet in the side column. (Figure 8)

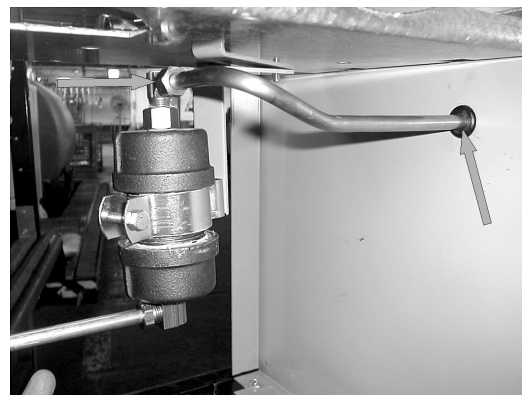

**Figure 8**

10. Tighten all loose connections. (Figure 9)
11. Turn on power to the pump. Open the shear valve's poppet for fuel flow into the pump. Close and lock the doors.

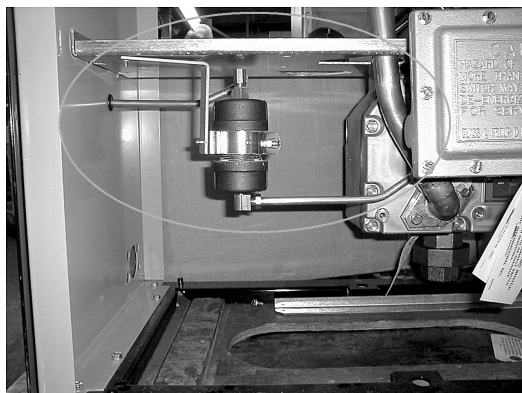

**Figure 9**