

Introduction

This manual contains parts information for Gasboy® Atlas® Series Satellite dispensers. Use this manual to identify part names, part numbers, and quantities required in a specific assembly.

How to Use This Manual

This manual provides detailed illustrations for Atlas Series Satellite dispensers. Match the callout numbers from an illustration to the corresponding table to find information on a part name, number, and quantity required for that assembly.

Table of Contents

Topic	Page
Introduction	1
How to Use This Manual	1
Sheathing and Doors	5
Frame	9
Hydraulics Area	10
Junction Box	12
Electronic Components	14

Parts Tables

The tables in this manual are set up as follows. Definitions for each column are provided after the table:

Item#	Description	Current Part	Previous Part	Quantity
1	Printed Circuit Assembly (PCA), Terminal Block Board	M00044A001	-	1
	• Plastic Printed Circuit Board (PCB) stand-off, 1/4-inch	Q10651-02	-	2

Item

The item # column provides digits that match callouts on the related illustrations.

Description

The description column provides a detailed name for each part from the illustration. Information such as colors, dimensions, or other details are provided, wherever applicable.

Current Part

The Current Part column provides current Gasboy part numbers for each item.

Previous Part

The Previous Part column provides old Gasboy part numbers that are no longer in use on current models. The previous part numbers are provided to identify obsolete items that may still be in the field. Notes are provided to clarify the difference between old and new parts, wherever possible.

Note: When substituting an old part for a new part, always ensure that parts are compatible.

Quantity

Quantity shown is per assembly. Quantity per unit varies depending on unit configuration. Use specification in parts table to obtain fasteners locally. Most kits contain hardware required for installation.

Bulleted Items (Located under Description)

These items are directly related to the previous part number listed. Parts are generally used for mounting or fastening hardware.

When Ordering Parts

The following items are to be considered while ordering Gilbarco® parts:

- 1 Furnish the model number, date code, and original options. This information is stamped on a serial plate located on the rail in the lower frame section (see [Figure 1](#) on [page 3](#)).
- 2 Provide the following information:
 - Part number
 - Quantity of the part required
 - Description of part
 - Color, graphics, and other details required for order-entry items.

*Note: **Order-entry item:** An item that can be ordered individually using its individual part number (not a part that is available only as part of a kit).*

Figure 1: Serial Plate

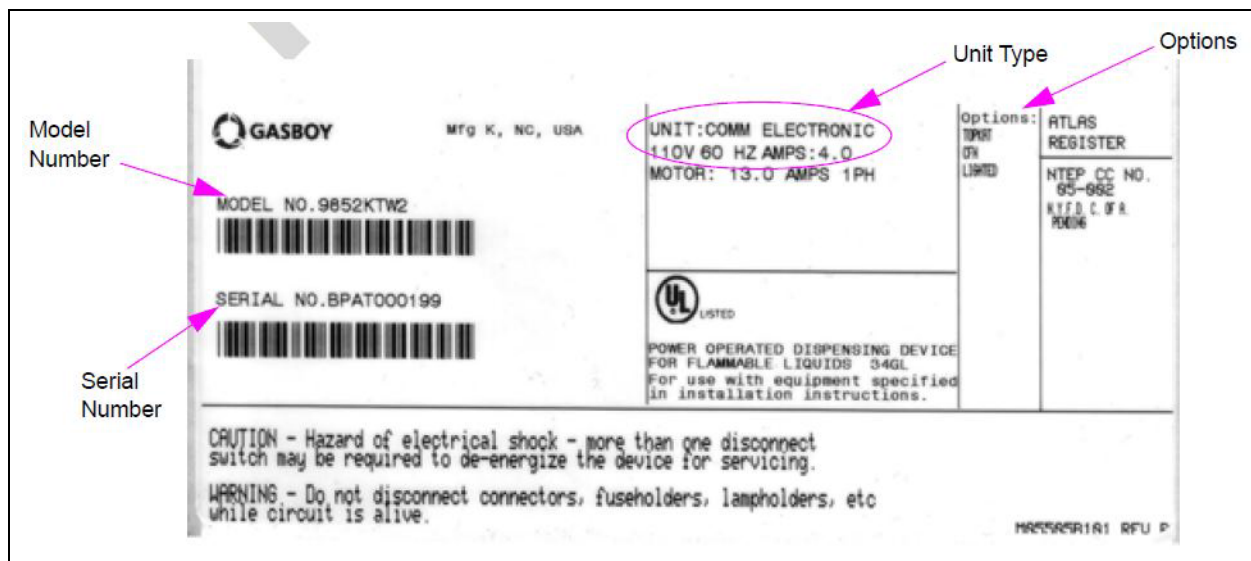

Model Number

The Model Number provides information on the configuration and options of the unit. The serial plate is located inside the hydraulics cabinet on the side of the satellite dispenser.

Date Code

The Date Code provides the month and year of manufacture. For example, a unit stamped BK was built in February 2001. Use the following chart as reference to determine date codes:

Month Codes		
A = January	E = May	J = September
B = February	F = June	K = October
C = March	G = July	L = November
D = April	H = August	M = December
Year Codes		
A = 2012	H = 2019	R = 2026
B = 2013	J = 2020	S = 2027
C = 2014	K = 2021	T = 2028
D = 2015	L = 2022	U = 2029
E = 2016	M = 2023	W = 2030
F = 2017	N = 2024	X = 2031
G = 2018	P = 2025	

Serial Number

The Serial Number identifies the unit, by customer.

Options

The Options column is a list of customer driven options per unit.

Unit Type

The Unit Type specifies the type of unit, i.e. Gasboy, Atlas commercial, or Mechanical.

Related Documents

Document Number	Title	GOLD SM Library
MDE-4906	Atlas 9216K/9216KTW Satellite Dispenser Installation/Operation Manual	Gasboy Atlas Pumps/Dispensers
MDE-4331	Atlas Fuel Systems Installation Manual	Gasboy Atlas Pumps/Dispensers
MDE-4334	Commercial and Retail Series Atlas Start-up/Service Manual	<ul style="list-style-type: none">• Gasboy Atlas Pumps/Dispensers• Service Manual
MDE-4430	Important Warnings and Safeguards	<ul style="list-style-type: none">• Gasboy Consumer• Gasboy Safety & Warranty Doc
FE-361	Atlas Master and Satellite Field Wiring Diagram	Gasboy Parts List & Wiring Diagrams
PT-1949	Atlas Pump and Dispenser Illustrated Parts Manual	Gasboy Atlas Pumps/Dispensers
PT-1950	Atlas Recommended Spare Parts List	Gasboy Atlas Pumps/Dispensers

Abbreviations and Acronyms

Term	Description
AC	Alternating Current
DC	Direct Current
GOLD	Gilbarco Online Documentation
I.S.	Intrinsic Safety
J-Box	Junction Box
NPT	National Pipe Thread
PCA	Printed Circuit Assembly
PCB	Printed Circuit Board
PSI	Pounds (of Pressure) per Square Inch

Sheathing and Doors

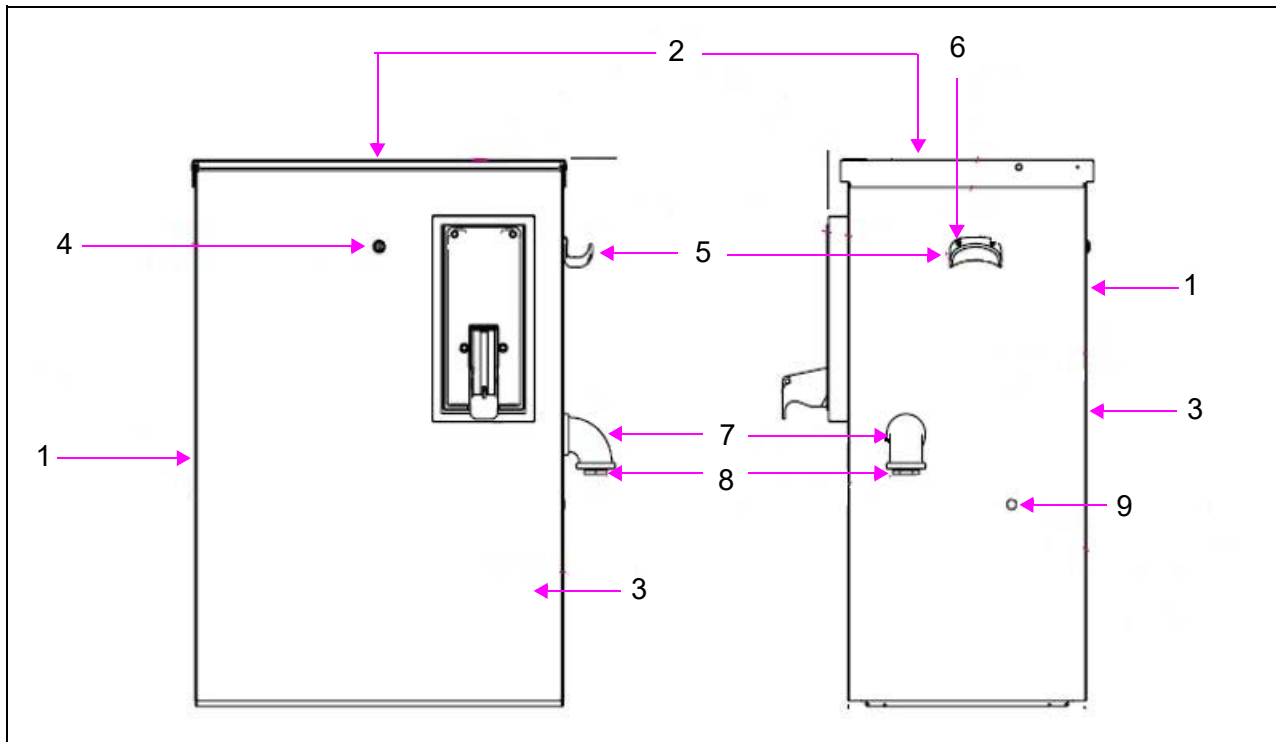

Item#	Description	Part Number	Quantity
1	Side Panels	Refer to "Single-sided Units" on page 6 and/or "Dual-sided Units" on page 6.	2 per unit
2	Top Panel	Refer "Top Panels" on page 6	1 per unit
3	Lower Door	Refer "Lower Doors" on page 7	2 per unit
4	Panel Lock & Key Kit	K34673	1 per door
5	Hose Hanger	G003740	1 per hose
6	Screw Tc Pnh Phl 10-32 X.62	Q11769-76	2 per hose
7	Elbow, 1-1/2 X 1-1/4 X 90° Painted Red	Z07941	1 per hose
8	Reducing Bushing Hexagonal 1-1/4 X 1	K02309-22	1 per hose
9	Plug, Cap .625 Dia Blk	Q10554-08	1 per hose

Side Panels

Single-sided Units

All single-sided units feature one blank panel and one discharge panel as noted in the following table.

Dual-sided Units

All dual-sided units feature two discharge panels as noted in the following table.

All panels are attached to the frame with four 12-24 X 1/2-inch long thread-forming pan head screws.

Stainless Steel	Painted (Black)	Panel Description
Model 9216K		
M10039B001	M10039B101PB0	Sheathing, Blank Panel
M10039B002	M10039B102PB0	Sheathing, Discharge Panel

Top Panels

All Atlas satellite dispensers use the same painted top. It is secured to the unit by 4 metric KEPS nuts (Q12885-07). For stainless-steel sheathing, a thin stainless-steel covering is pop riveted (Q10084-44) over the painted top. Refer to the following table, to select the appropriate top panel for your unit.

Figure 2: Painted and Stainless Steel Panels

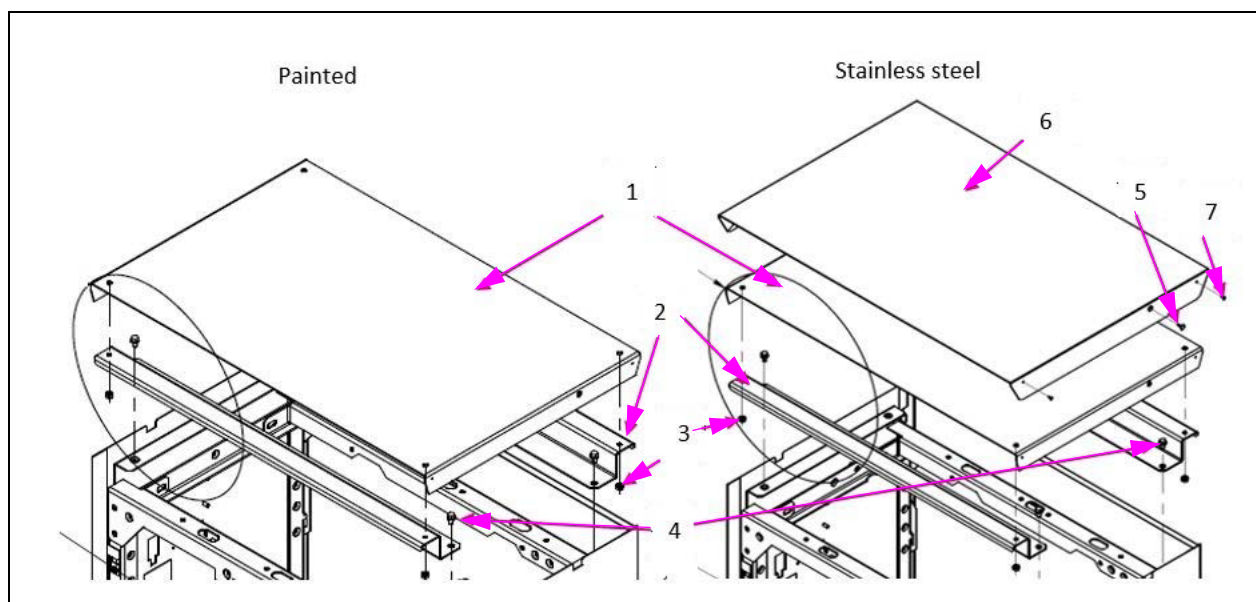

Item#	Description	Part Number	Quantity
1	Assy, Top Cover Atlas Satellite, Black	M10012A001PB0	1 per unit
2	Bracket, Top Cover	M09982B001	2 per unit
3	Nut, Metric Hex Keps M6	Q12885-07	4 per unit
4	Screw, Metric M6 X 10 Hex Wshr Hd Thd Form Type C	M00417B104	4 per unit
5	Clip, Plastic Plug-In Black	M06607B001	2 per unit
6*	Cover, Top, Atlas Satellite Sstl	M10100B001	1 per unit
7*	Pop Rivet, .094 X.250 Sst	Q10084-44	4 per unit
*Stainless steel top only.			

Lower Doors

Select the appropriate door or door part for unit from the following table:

Note: All units have two doors.

Door Description	Finish Description	Part Number	Quantity
Lower Door, No Cutout	Stainless Steel	GK01003GA001	1 per Single Unit
	Painted or Decaled	GK01003GA____	1 per Single Unit
Lower Door with Boot Cutout	Stainless Steel	GK01004GA001	1 per Single Unit, 2 per Dual Unit
	Painted or Decaled	GK01004GA____	1 per Single Unit, 2 per Dual Unit
Notes: 1) Nozzle boot covers are included with front-load doors.			
2) Ensure to include full part numbers when ordering painted or decaled doors.			

Front-Load Nozzle Boot

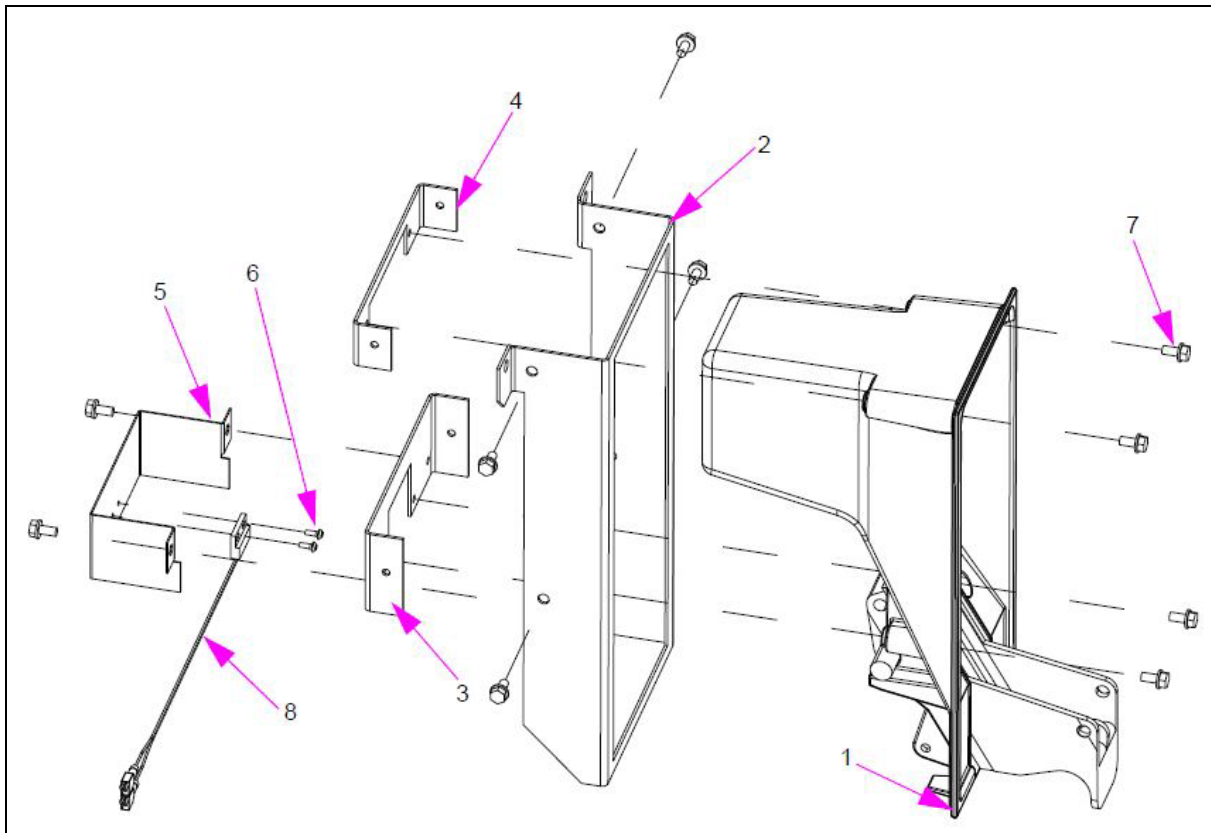

Item #	Part Description	Current Part	Previous Part	Quantity
	Assembly, Front-load Nozzle Boot	M04827A001	-	1
1	Assembly, Nozzle Boot	W03879-G1	-	1
2	Bracket, Nozzle Boot Mounting	M04826B001	-	1
3	Bracket, Nozzle Boot Mounting	M04829B001	-	1
4	Bracket, Nozzle Boot Mounting	M04829B002	-	1
5	Bracket, Switch Mounting	M05314B001	-	1
6	Screw, 6-32 X 3/8 Panhead	Q11769-15	-	2
7	Screw, T8, Hexagonal Washer Head M6 X 12	K85736-51	-	10
8	Sensor Assembly - Nozzle Boot	C04243	-	1

Frame

Dispenser Frame

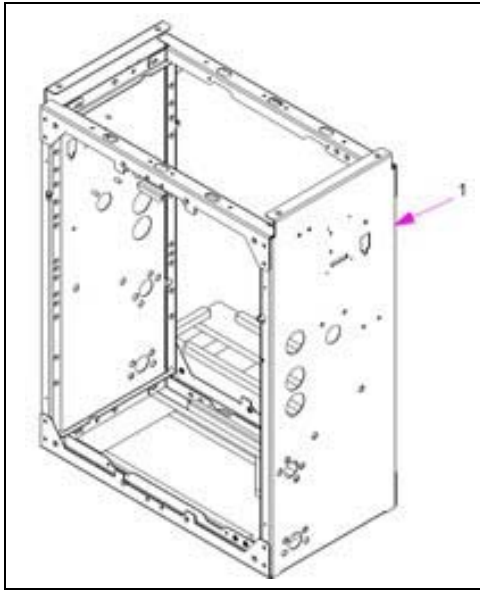

Item #	Part Description	Current Part	Previous Part	Quantity
1	Assembly Frame Weldment	M08928A003	-	1

Lower Dispenser Frame (Hydraulic Support)

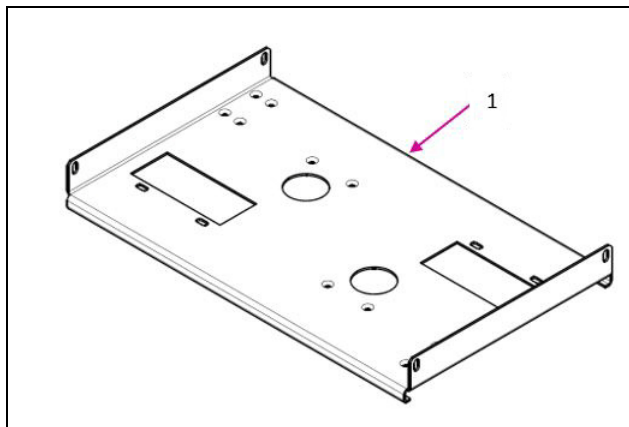

Item #	Part Description	Current Part	Previous Part	Quantity
1	Bracket, Piping Support Atlas Satellite	M11018B001	-	1
2	Screw, Metric M8 X 18 (not shown)	M00417B009	-	4

Hydraulics Area

Lower Hydraulics

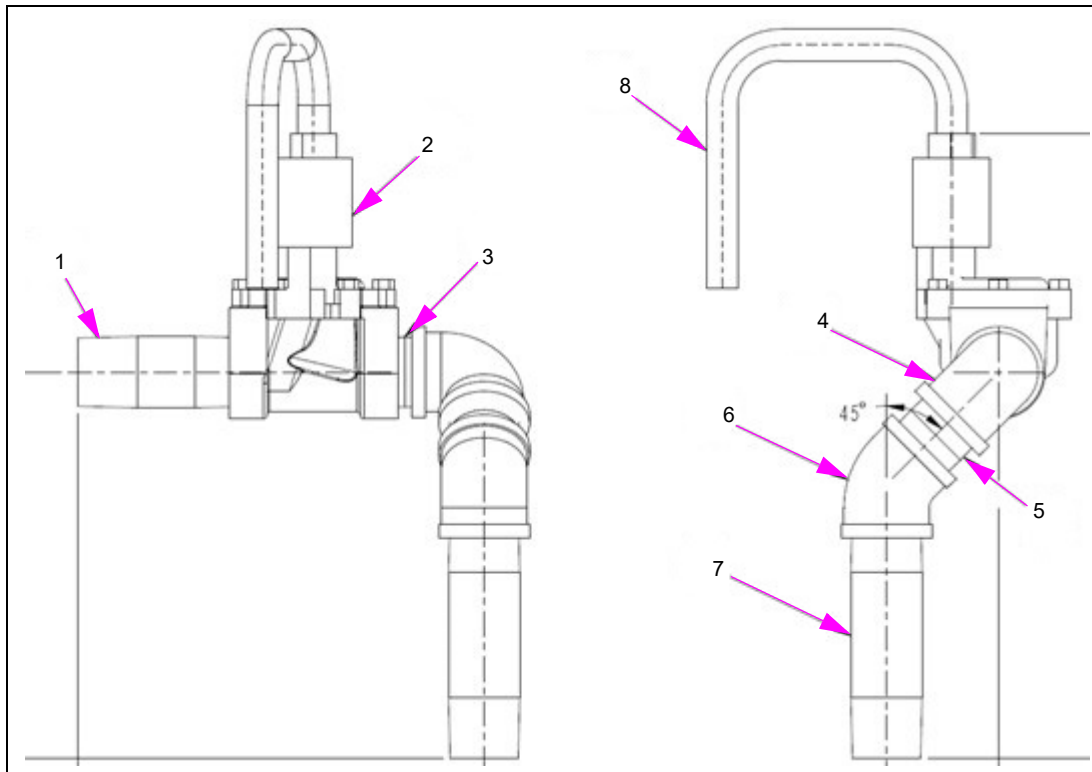

Item #	Part Description	Current Part	Previous Part	Quantity
1	Nipple, 1-1/2 X 4.75 Lg Fe Pipe	R11493-92	-	1
2	Solenoid Valve, 115V 2Stg	G067028	-	1
	Solenoid Valve, 230V 2Stg	G067062	-	1
3	Nipple, 1-1/2 X 1-3/4 Lg Fe Pipe	R11493-77	-	1
4	Elbow, 1-1/2 X 90 Deg	K46046	-	1
5	Nipple, 1-1/2 X 2-1/4 Lg Fe Pipe	R11493-24	-	1
6	Elbow, 1-1/2 X 45 Deg	G024902	-	1
7	Nipple, 1-1/2 X 6-9/16 Lg Fe Pipe	R11493-46	-	1
8	Conduit, Solenoid Valve Atlas Satellite	M10487B001	-	1

Lower Hydraulic Mounting

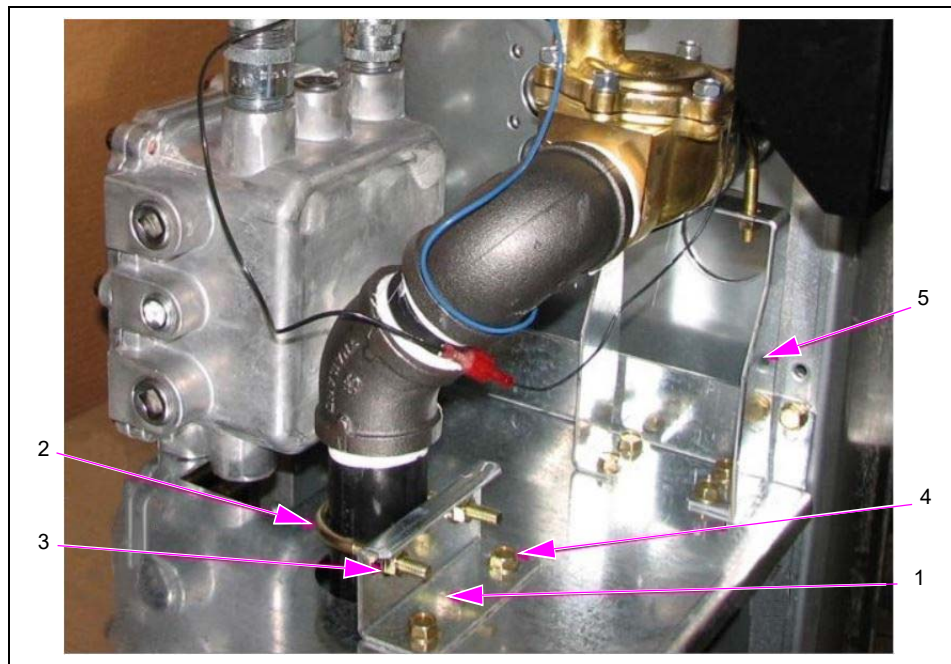

Item #	Part Description	Current Part	Previous Part	Quantity
1	Bracket Discharge Support	M02332B001	-	1
2	U-Bolt, Metric, M8	M00703B002	-	2
3	Nut, Metric M8 Serrated Flange	M00414B003	-	4
4	Screw, Metric M8 X 18 Thread Former	M00417B009	-	6
5	Bracket, Outlet, Pipe Support	M10488B001	-	1

Junction Box

Junction Box - Single Unit

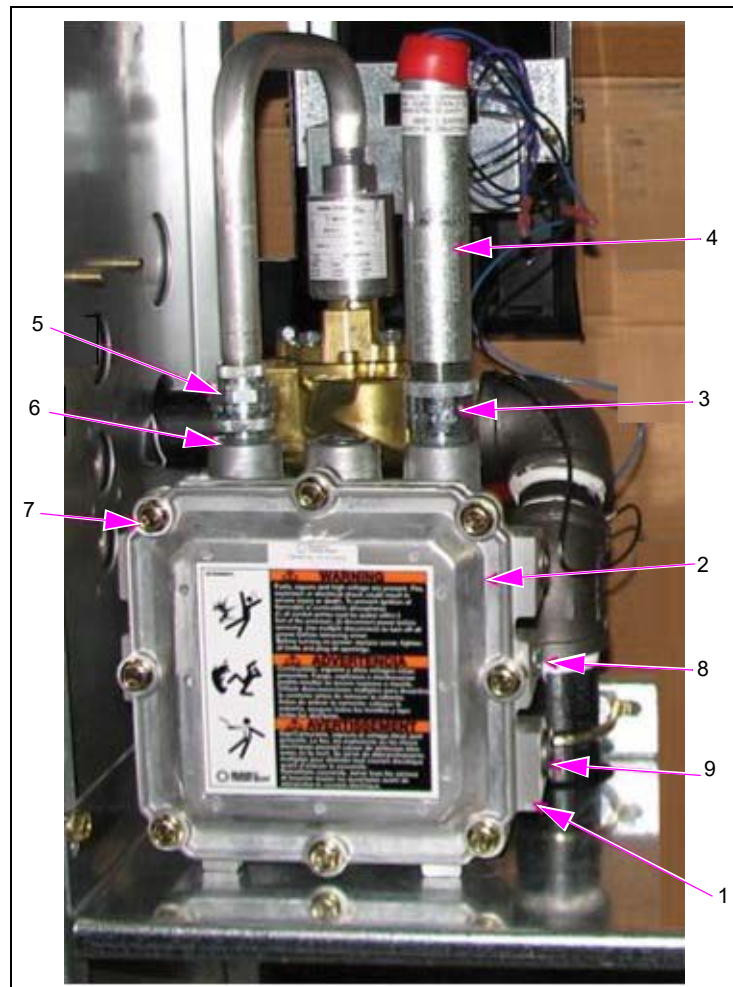

Item #	Part Description	Current Part	Previous Part	Quantity
1	Junction Box	M04480B010	-	1
2	Cover, Junction Box	M04536B010	-	1
3	Enlarger, Conduit, Male 3/4" M X 1" F	M10035B001	-	1
4	I.S. Barrier Assy	C06882	-	1
5	Union, Conduit 1/2 inch	Q10016-04	-	1
6	Bushing, Reducing 3/4 - 1/2	K49827	-	1
7	Screw, Metric M8 X 20 Serrated Flange Head	M00415B010	-	8
8	Plug Pipe 1/2 Sq Socket Csk Hd Stl	K43850	-	3
9	Plug, 3/4" Npt Pipe	K57624	-	4
10*	Plug, 1" Npt Pipe	K51440	-	1
*Not shown				

Junction Box - Dual Unit

Dual units will have two junction boxes and a conduit running between them. Parts for the junction boxes are the same as the single (shown above) except for the joining conduit (shown below).

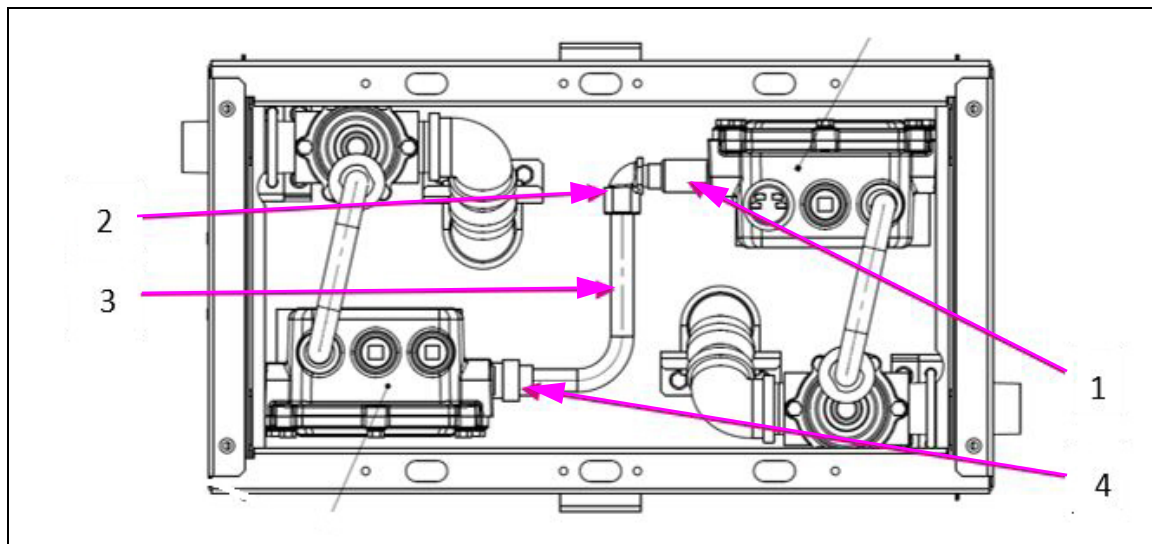

Item #	Part Description	Current Part	Previous Part	Quantity
1	Union Exp Std 1/2" M&F Stl	N16289-20	-	1
2	Elbow, 1/2" Npt Conduit	K42448	-	1
3	Conduit, 1/2" J-Box Atlas Satellite	M10482B001	-	1
4	Union, Conduit 1/2 inch	Q10016-04	-	1

Electronic Components

Satellite I.S. Barrier Assembly C06882

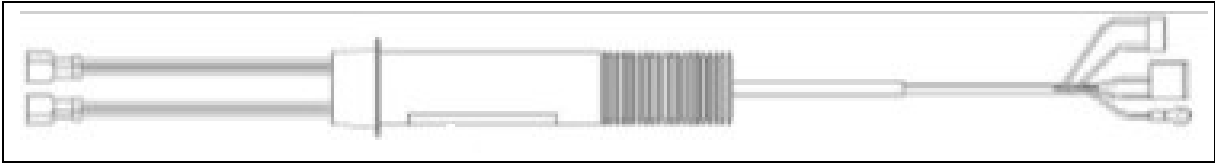

Satellite Control PCA

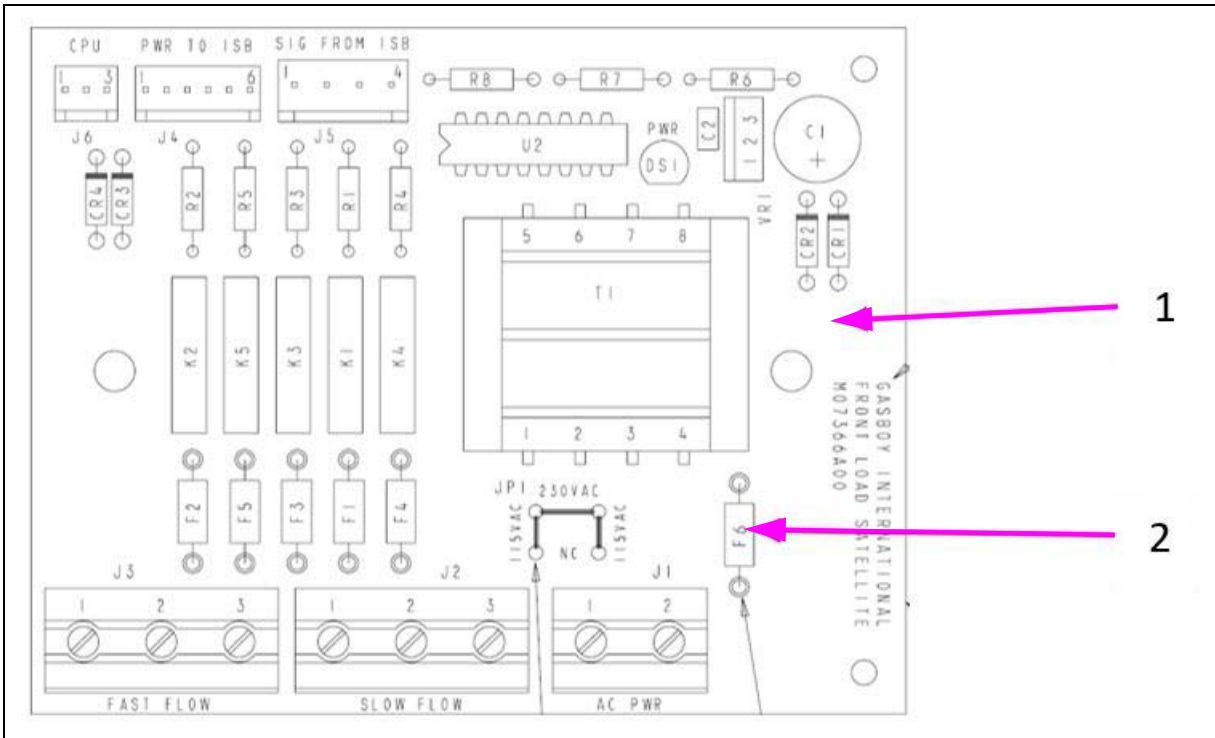

Item #	Part Description	Current Part	Previous Part	Quantity
1	Pca, Front Load Sat Rel (115VAC)	M07366A001	-	1
	Pca, Front Load Sat Rel (230VAC)	M07366A002	-	1
2	Fuse Axial Lead 1/2 Amp 125V	Q11374-05	-	6

Satellite Control PCA Support Bracket M09963A001

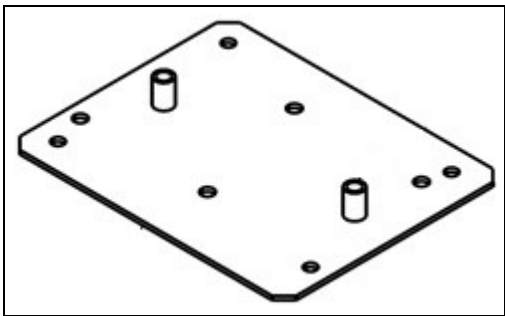

Satellite Cable (Dual units only)

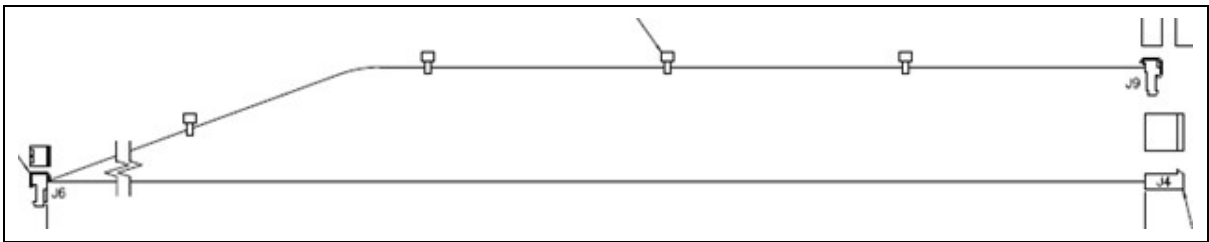

Item #	Part Description	Current Part	Previous Part	Quantity
1	Cable, 9850 Combo Adapter (Atlas Combo)	M07424A002	-	1

Atlas®, Gasboy®, and Gilbarco® are registered trademarks of Gilbarco Inc. GOLDSM is a service mark of Gilbarco Inc.

All product names, logos, and brands are the property of their respective owners and are for identification purposes only. Use of these names, logos, and brands does not imply endorsement.



© 2021 Gilbarco Inc. All Rights Reserved
7300 West Friendly Avenue · Post Office Box 22087
Greensboro, North Carolina 27420
Phone (336) 547-5000 · <http://www.gilbarco.com> · Printed in the U.S.A.
PT-1972A Atlas® 9216K/9216KTW Series Satellite Illustrated Parts Manual · June 2021